



Congratulations on your Guide Gear purchase.

Take your game to the next level with field-tested Guide Gear products for a confident, competitive edge that strikes the perfect balance between performance and value.

DELUXE CLIMBER STAND

(The Sportsman's Guide item # 177426)

Single User Maximum Field Rating - 300 lb (This is the maximum combined total weight of the user, their clothing, and gear while on the platform and/or seat) No more than one person should occupy any part of this stand at any time.

Tree Diameter Range - 8" to 20" (Select only strong, healthy trees that are straight with no loose bark)

⚠ A safety video is included with this product. DO NOT attempt to assemble, install or use this product until you have watched and understood the video and are able to practice the safe hunting techniques it describes.

⚠ Keep this manual, the fall arrest harness manual and the safety video in a secure location and review them at least annually.

Before beginning assembly, check your purchase for damaged or missing parts. Do not use if you identify damaged or missing any parts. For help with damaged or missing parts, call toll free at 877-284-9005 (reference **Model # 02-MKCLMR-001GG**)

For assistance with your Guide Gear product, please contact the Sportsman's Guide customer service at 1-800-888-5222 7:30am – 6:00pm CST Mon-Fri or go to <http://www.sportsmansguide.com/customerservice/contactus>



⚠ WARNING

YOU MUST COMPLETELY READ, UNDERSTAND, AND FOLLOW THE WARNINGS AND INSTRUCTIONS CONTAINED IN THIS MANUAL, THE FALL ARREST HARNESS MANUAL, AND ENCLOSED SAFETY VIDEO. FAILURE TO DO SO MAY RESULT IN SERIOUS INJURY OR DEATH!

www.SportsmansGuide.com



PRODUCT MEETS
INDUSTRY STANDARDS
RECOGNIZED BY



P/N: 02-MKCLMR-001GG

REV2: 01/23/18

© 2018 DOP

All Rights Reserved.

INTRODUCTION

Follow these few simple instructions and your stand will provide you many years of trouble-free pleasure. Instructions should be kept in a safe place and reviewed at least annually.

CONTENTS

Introduction/Contents/Treestand Safety Guidelines	2
Warnings.....	3-4
Inspection and Maintenance Schedule	4
Assembly Instructions	5-6
Set Up and Use	7-8
Illustrated Parts Breakdown.....	9-11
Warranty	12

TREESTAND SAFETY GUIDELINES – READ FIRST

USE A FULL-BODY FALL ARREST HARNESS SYSTEM

ALWAYS wear and properly use a Full Body Fall Arrest Harness System (FBFAHS) that meets stringent, industry standards recognized by TMA. Wear a FBFAHS every time you leave the ground, including while ascending or descending. Single strap belts and chest harnesses are no longer allowed and shall not be used. Failure to use a FBFAHS could result in serious injury or death.

USE YOUR HARNESS PROPERLY

ALWAYS attach your Full Body Fall Arrest Harness System (FBFAHS) in the manner and method described by the manufacturer. The FBFAHS tether should have no slack when sitting. Failure to do so may result in suspension without the ability to recover into your treestand. Be aware of the hazards associated with hanging suspended in a Full Body Fall Arrest Harness System (FBFAHS) and the fact that prolonged suspension in a harness may be fatal.

READ, UNDERSTAND, AND FOLLOW THE INSTRUCTIONS

ALWAYS read and understand the manufacturer's WARNINGS and INSTRUCTIONS before using a treestand and Full Body Fall Arrest Harness System (FBFAHS) each season. If you have any questions after reviewing the WARNINGS and INSTRUCTIONS, please contact the manufacturer. Maintain the WARNINGS and INSTRUCTIONS for later review as needed, for instructions on usage to anyone borrowing your stand or harness, or to pass on when selling these items. Use all safety devices provided with your treestand. NEVER exceed the weight limit specified by the manufacturer.

USE A HAUL LINE

ALWAYS use a haul line to raise your backpack, gear, unloaded firearm or bow to your treestand once you have reached your desired hunting height. Never climb with anything in your hands or on your back. Prior to descending, lower your equipment on the side of the tree opposite of your descent route.

PRACTICE BEFORE HUNTING

ALWAYS practice using your Full Body Fall Arrest Harness System (FBFAHS) in the presence of a responsible adult prior to using it in an elevated hunting environment, and learn what it feels like to hang suspended in the harness at ground level. Practice installing and using your treestand at ground level and with a responsible adult present before you go hunting.

HAVE A PLAN FOR RECOVERY/ESCAPE

ALWAYS have a plan in place for rescue, including the use of cell phones or signal devices that may be easily reached and used while suspended. If rescue personnel cannot be notified, you must have a plan for recovery/escape. If you have to hang suspended for a period of time before help arrives, exercise your legs by pushing against the tree or doing any other form of continuous motion. Failure to recover in a timely manner could result in serious injury or death. If you do not have the ability to recover or escape, hunt from the ground.

REPLACE DAMAGED OR EXPIRED HARNESSES AND STANDS

ALWAYS inspect the treestand and the Full Body Fall Arrest Harness System (FBFAHS) for signs of wear or damage before each use. Contact the manufacturer for replacement parts. Destroy all products that cannot be repaired by the manufacturer and parts that have exceeded the recommended expiration date. Destroy products if the manufacturer no longer exists. The FBFAHS must be discarded and replaced after a fall has occurred.

BE PREPARED AHEAD OF TIME

ALWAYS let others know your exact hunting location, when you plan to return and who is with you before you go hunting. Hunt with a buddy – it's more enjoyable and you'll have someone to help if an emergency situation arises.

CARRY EMERGENCY SIGNAL DEVICES

ALWAYS carry emergency signal devices such as a cell phone, two-way radio, whistle, signal flare, PLD (personal locator device) and flashlight on your person at all times and within reach, even while you are suspended in your FBFAHS. Watch for changing weather conditions. In the event of an accident, remain calm and seek help immediately.

SELECT A SAFE TREE

ALWAYS select the proper tree for use with your treestand. Select a live, healthy and straight tree that is within the size limits recommended by the manufacturer. Never select a leaning tree. Never leave a treestand installed for more than two weeks since damage could result from changing weather conditions and/or from other factors not obvious with a visual inspection.

KNOW YOUR LIMITS

ALWAYS know your physical limitations. Don't take chances. If you start thinking about how high you are, don't go any higher.

DON'T RUSH – BE SAFE!

NEVER hurry! While climbing with a treestand, make slow, even movements of no more than ten to twelve inches at a time. Make sure you have proper contact with the tree and or treestand every time you move. When using any treestand with a ladder or steps, maintain three points of contact with each step. This means having two hands and one foot (or one hand and two feet) in contact at all times.

ONLY USE CERTIFIED EQUIPMENT

NEVER use homemade or permanently elevated stands. NEVER make modifications to a purchased treestand without the manufacturer's written permission. Only purchase and use treestands and Fall Arrest Harness Systems (FBFAHS) that meet or exceed industry standards recognized by TMA. For a detailed list of products that are certified to industry standards recognized by TMA, contact the TMA office or refer to the TMA web site at www.tmastands.com.

MODEL 02-MKCLMR-001GG

MAXIMUM OCCUPANCY - ONE (1)
TOTAL WEIGHT LIMIT - 300 LB
TREE DIAMETER RANGE - 8" TO 20"

WARNING

- ▲ This product carries strict weight restrictions. **Do Not** use this product if you exceed the total weight limit. Please note that the total weight limit includes the user(s) and their equipment.

WARNING

- ▲ **When hunting from a treestand falls can occur any time after leaving the ground causing injury or death.**
- ▲ **Always** wear a Fall Arrest System (FAS) comprising a full body harness at all times after leaving the ground. You must stay connected at all times after leaving the ground while using climbing and hang-on treestands. Single safety belts and chest harnesses are no longer allowed and shall never be used. If you are not wearing a full body harness properly attached to the tree that is protecting you from a fall, do not leave the ground.
- ▲ **Read and understand** all of the manufacturer's Warnings and Instructions and use all safety devices provided by the manufacturer. Contact the manufacturer for any questions. Failure to do so could result in injury or death.
- ▲ **Never** exceed the total weight limit of the treestand.
- ▲ **Never** use a treestand during inclement weather such as rain, lightning, windstorms or icy conditions and end your hunt and return to the ground if inclement conditions arise.
- ▲ **Never** use a treestand while using drugs (even prescription drugs) or alcohol.
- ▲ **Never** use a treestand while feeling ill, nauseous or dizzy, or if you have a prior medical condition that could cause a problem, that is, heart condition, joints that lock-up, spinal fusions, etc., or if you are not well rested. **Never** sleep in stand.
- ▲ **Never** use a treestand on a dead, leaning, diseased or loose barked tree, or a utility pole. **Always** avoid electrical power lines.
- ▲ **Never** rely on a tree branch for support.
- ▲ **Never** jump or bounce on a treestand to seat it to the tree.

WARNING

- ▲ Pull up a bow, backpack, or firearm or other equipment only after being secure in the treestand and a firearm must be pulled up with it unloaded, chamber open, and muzzle down.
- ▲ **Always** inform someone of the hunting location, where the treestand will be located and the expected duration of the hunt.
- ▲ A signal device such as a mobile phone, radio, whistle, signal flare or personal locator device (PLD) must be on your person and readily available at all times.
- ▲ Inspect the treestand and all safety devices each time before use and **Do Not** store a treestand outdoors when not in use.
- ▲ **Never** modify your treestand in any way by making repairs, replacing parts, or altering it except if explicitly authorized in writing by the manufacturer.
- ▲ Practice installing, adjusting and using your treestand at ground level prior to using it at elevated positions. Study your new stand to become familiar with all of its features and design. Doing so will confirm that the product is manufactured, assembled and installed correctly.
- ▲ Instructions (written and video) shall be kept in a safe place and reviewed at least annually. It is the responsibility of the treestand owner to furnish the complete instructions to any person who borrows or purchases the treestand.
- ▲ The initial angle of the platform/climber at ground level must allow for the decrease in tree diameter while ascending by tilting slightly upward.
- ▲ For two-piece climbing treestands the tether/safety rope connecting the top and the platform must be secure and at the length recommended by the manufacturer.
- ▲ Platform level adjustments shall not be made anywhere except at ground level (except for those special cases of products designed and intended to be safely adjusted in accordance with the manufacturer's instructions).
- ▲ While climbing, adjustments to the harness attachment to the tree (tether/tree belt) shall be frequent and coordinated with treestand movement to maintain the least amount of slack in the tether that will allow for climbing.
- ▲ Familiarize yourself with the use of climbers by practicing at ground level before using in a hunting environment.
- ▲ **Do Not** use this product until you have watched the included treestand safety DVD, understand it, and practiced the techniques for safe hunting discussed in this DVD.

WARNING

- ▲ Read and perform all inspection and maintenance tasks before each and every use. Replace any questionable components immediately with DOP original replacement parts.
- ▲ **Do Not** crush tubing when tightening bolt assemblies! Identify and familiarize yourself with all parts before you start. A bolt identification card can be found in the back.
- ▲ Double check assembly steps to be certain you have correctly assembled this product.
- ▲ **Never** use any product that has not been maintained or inspected properly - Your life depends on it!
- ▲ Replace any and all treestand straps every two years or when signs of damage or wear exist before.
- ▲ **Do Not** tie the safety rope around the tree blade teeth. Damage to the rope will occur and cause failure.
- ▲ The safety rope is used to secure both platforms together to ensure the platforms will not fall away from each other while climbing, **Do Not** omit this step. Failure to secure platforms together can cause you to be stranded in the tree.
- ▲ Make sure both platforms are "strapped" tightly to the tree with the provided cam lock straps before standing.
- ▲ Correct tightening and adjustments of chains, cables, straps, etc. are critical to stable climber treestand installation.
- ▲ Be sure to raise and lower your weapon with a haul line. Gun barrel end or arrow tips must be pointed down and away from you.
- ▲ **Always** wear the appropriate footwear when using a climber treestand. A good non-slip safety boot is important to your personal safety. Be especially careful that boot laces do not get hooked on the stand or any of its components (tuck shoelaces into boots before climbing).
- ▲ **Never** lean out over edge of device.

INSPECTION AND MAINTENANCE SCHEDULE

BEFORE EACH USE PERFORM THE FOLLOWING:

- Inspect all webbing, rope, cord, and strap assemblies for wear or damage.
- Inspect cables and/or cable ends for damage or kinking.
- Inspect all hardware and chain components for damage.
- Inspect for any structural damage to product. (If any exists call DOP customer service.)
- Inspect all nut and bolt assemblies to be certain none are loose.
- Inspect for any missing parts.
- Lubricate all pivot and slide together points with powder graphite, petroleum jelly or silicone spray to prevent noise, wear and rust.
- Inspect entire product for any rust, corrosion, cracks, freezing, excessive heat or rotting damage that may effect the safety of your product. Discard any questionable product.
- Inspect entire product for any structural damage - pay close attention to all weld locations. (Return to factory for repair or discard product if any damage is found.)
- Using correct wrenches inspect all nut & bolt assembly locations and snug up any that may be loose. Be careful not to crush tubing when tightening!
- Inspect and check operation of all cables, cable ends, cord, rope, webbing, and strap or chain assemblies. Replace with factory new any item or assembly that shows signs of wear, damage, kinking, or functions incorrectly.
- Inspect seat. Replace any seat with factory new that shows signs of structural damage or wear.
- Inspect all hardware for wear or damage, also be sure you have no missing parts.
- Never modify your stand in any way by making repairs, replacing parts, or altering adding or attaching anything to it except if explicitly authorized in writing by the manufacturer.

ASSEMBLY INSTRUCTIONS

Tools needed: two 13mm wrenches

IMPORTANT ASSEMBLY TIP:

Do not tighten any nut and bolt combinations completely until all parts are assembled together! Finger tighten plus one turn of a wrench only! This will temporarily hold the lock nut on the bolt while helping alignment of all parts! After all parts are assembled together, all nut & bolt combinations must be completely tightened.

All assembly must be done in this order at ground level before uprighting.

Do not remove labels/warnings from product, they are there for your safety.

Recommended for adult use only.

Platform Assembly:

1. Unpack all components and place on a clean surface.
Refer to the "ILLUSTRATED PARTS BREAKDOWN" for part identification and location.
- Note: Some components come factory installed**
2. Remove the M8 hand knob (11) from M8x70mm bolt (9).
3. Pivot seat frame support (2) up and over the M8x70mm bolt (9).
4. Install the M8x70mm bolt (9) and the hand knob (11) and tighten by hand.
5. Install the spring lock pin (10) through the tab on the seat frame (4) and the seat frame support (2).
6. Repeat Steps 1-5 to assemble the foot platform (5).
7. Insert one end of the steel cable (6) into the cable support tube (1) on the seat frame (4).
8. Secure the cable by inserting a spring lock pin (10) through the cable support tube and eyelet on the cable.
9. Repeat Steps 7&8 on the foot platform (5) assembly.
10. Make sure all hardware and components are correctly installed and aligned. **Tighten all nut & bolt assemblies. Be sure not to over tighten or crush tubing when tightening!**

Seat and Covers Assembly:

1. Place the seat and back rest cushion (21) between the arm rests of the seat frame (4) and behind the attach point of the cable support tubes (1).
2. Loop the seat straps over and under the seat frame (4).
3. Insert the loose strap end through the first buckle slot.
SEE FIGURE 1
4. Pull the strap through the buckle and reverse through the second slot near the end of the buckle.
5. Pull the strap tight and repeat for the second seat strap.
6. Attach the arm rest/shooting rail covers (22).

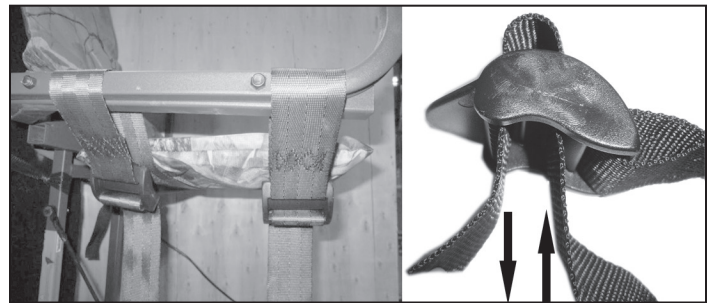

FIGURE 1

Assemble Foot Straps (13) to Foot Platform (5):

1. Attach the two cam buckle straps (13) to each side of the center cross tube on the foot platform (5). Loop the strap around the tube, then put the cam buckle through the looped end and cinch tight.
2. Find the center of the long strap and attach it to the center of the cross tube by looping the strap around the tube. **SEE FIGURE 2**

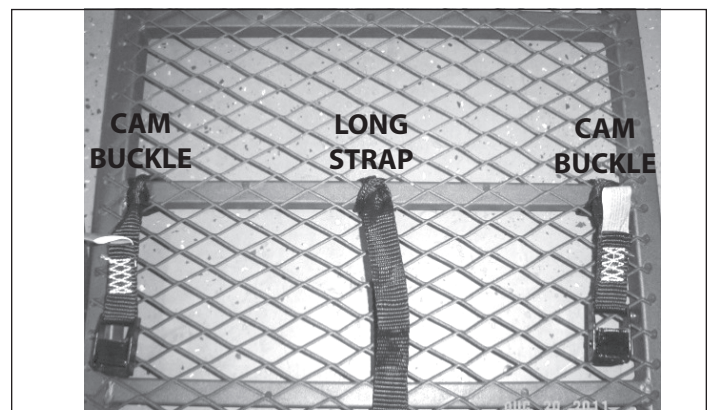

FIGURE 2

3. Place each end of the long strap through the cam buckles. **SEE FIGURE 3**
4. Place you feet in between the straps and pull tight on the long strap to adjust.



FIGURE 3

WARNING

- ▲ **All** users are responsible for ensuring climber stand is attached to tree properly and securely. Failure to do so may result in serious injury or death. Read and understand all instructions for proper installation procedure and product warnings before use.

WARNING

- ▲ **Only** use approved DOP parts. Failure to do so may result in serious injury or death!

WARNING

- ▲ Double check assembly steps to be certain you have correctly assembled this product.
- ▲ Practice installing, adjusting and using your treestand at ground level prior to using it at elevated positions. Study your new stand to become familiar with all of its features and design. Doing so will confirm that the product is manufactured, assembled and installed correctly.
- ▲ **Do Not** tie the safety rope around the tree blade teeth. Damage to the rope will occur and cause failure.
- ▲ The safety rope is used to secure both platforms together to ensure the platforms will not fall away from each other while climbing, **Do Not** omit this step. Failure to secure platforms together can cause you to be stranded in the tree.
- ▲ Make sure both platforms are "strapped" tightly to the tree with the provided cam lock straps before standing.
- ▲ Correct tightening and adjustments of chains, cables, straps, etc. are critical to stable climber treestand installation.
- ▲ Be sure to raise and lower your weapon with a haul line. Gun barrel end or arrow tips must be pointed down and away from you.
- ▲ **Always** wear the appropriate footwear when using a climber treestand. A good non-slip safety boot is important to your personal safety. Be especially careful that boot laces do not get hooked on the stand or any of its components (tuck shoelaces into boots before climbing).
- ▲ If seat is removable, be certain it is securely attached when in use.
- ▲ **Never** stand on seat, it is designed for sitting only.
- ▲ Some models include a footrest, which is designed as a footrest only. **Never** stand on footrest! **Always** be fully aware of foot placement.

SET-UP AND USE INSTRUCTION

During installation and removal of a climbing tree stand, you must always and properly use the included Full Body Harness (Fall Arrest System) with tree belt. Refer to the full body harness and tree belt instructions that came with this product to learn proper use. You must always use a full body harness when using this product.

Attaching your Stand to the Tree:

1. While wearing your FULL BODY HARNESS (19) and TREE BELT, position your treestand on the desired tree and attach as follows:
 - a. Position the foot platform assembly against the tree. Wrap the steel cable (6) around the tree and insert one end of the steel cable into the cable support tube (1) on the foot platform (5).
 - b. Secure the steel cable (6) by inserting a spring lock pin (10) through the cable support tube (1) and eyelet on the steel cable.
2. Position the seat platform assembly above the foot platform assembly. Repeat Steps 1 a & b. to attach the seat platform assembly to the tree.
3. Attach the safety rope (16) to the rear of the seat platform assembly and the rear of the foot platform assembly.
4. Reverse the "Set-Up and Use Instructions" to remove the treestand from the tree.

Climbing Up the Tree: SEE FIGURE 4

1. With your safety harness (19) attached, and your tree belt (not included) attached to the tree (per manufacturers instructions), step onto the foot platform and place each foot into the foot strap loops and tighten.
2. Attach the Bungee cord (17) to the foot platform and behind both shoe heels to help keep your feet in the foot strap loops (13).

NOTE: Make sure you have both Cam Lock Straps (15) in your pocket before leaving the ground.

3. Stand and lift up on the seat platform to adjust it to a comfortable (below chest height) position. Pull the steel cable into the tree and push down on the outside edge of the seat platform. This will set the tree claw into position on the tree.

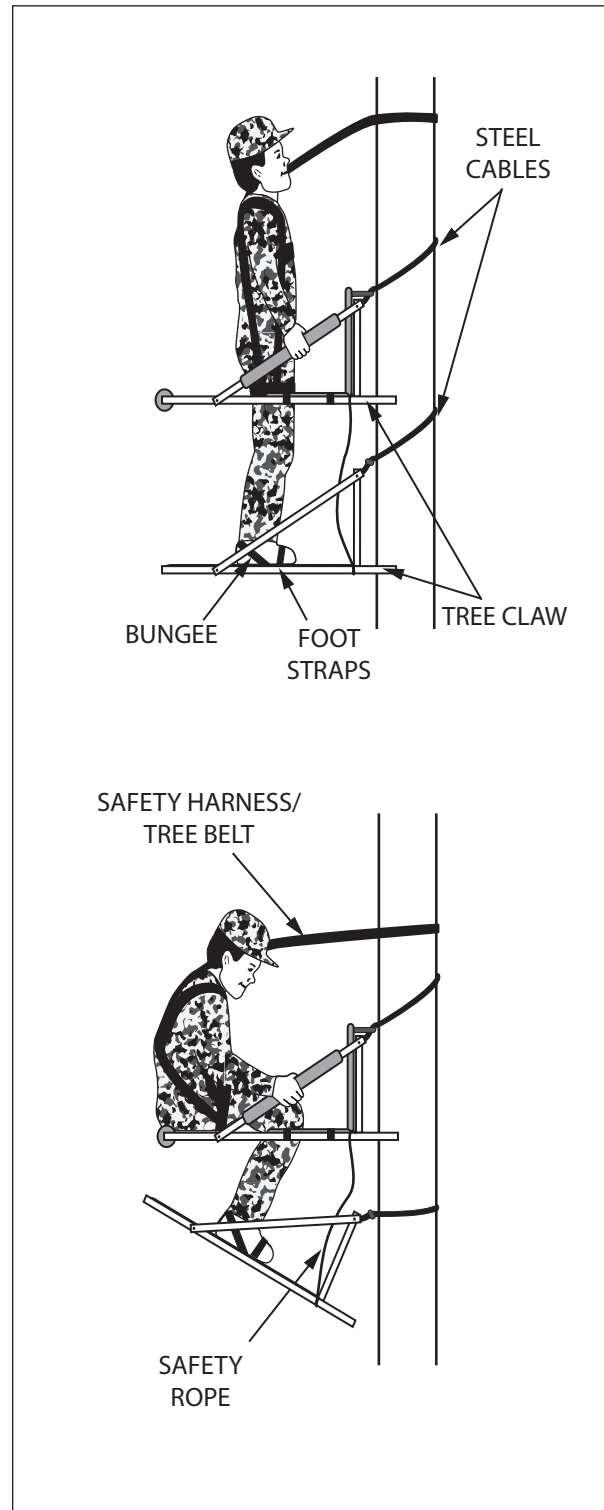

FIGURE 4

4. Sit on the forward edge of the seat platform. Push your toes down to release the bottom section from the tree. Lift your feet to raise the foot platform. Push down with your heels to set the tree claw into position on the tree.

NOTE: Do not take large steps up the tree. Each step should move you no more than ten to twelve inches. Repeat steps to get to the desired height.

Reverse the above procedure to climb down the tree. Take smaller (shorter) steps when descending. Do not extend too far or an uncomfortable or dangerous condition can occur.

Make frequent adjustments to the harness attachment as you move up or down the tree. Keep the least amount of slack in the harness tether that still allows for climbing.

Securing to the Tree:

1. Wrap a cam lock strap (15) around the steel cable (6) that is attached to the tree stand. The cam lock strap must be wrapped in front of the tree trunk then pulled tight to secure the seat platform in place.
2. Repeat Step (1) to secure the foot platform to the tree with a cam lock strap (15).
3. Remove the bungee cord (17) from the foot platform and carefully remove one foot at a time.
4. Attach the backrest portion of the seat cushion (21) to the tree by wrapping the bungee around the tree and hooking together.
5. Keeping both feet on the foot platform, slowly turn around and sit on the seat cushion.
6. Reverse these procedures to climb down the tree and remove the stand. Make sure you adjust your safety harness and tree belt as you ascend and descend the tree.

Transporting your Stand:

1. Remove the seat cushion (21).
2. Remove the hand knob (11) and spring lock clip (10) from the foot platform assembly. Lift up on the foot platform support (3) and pivot until it rests flat on the foot platform (5).
3. Place the foot platform assembly on top of the seat frame assembly. Use the two pack strap (18) to tie the platform assemblies together.
4. Place the seat cushion on top of the foot platform. Place the seat straps under the platform assemblies and attach the seat strap buckles.

NOTE: Make sure you pack the items so you do not interfere with the placement of the shoulder harness straps (14).

ILLUSTRATED PARTS BREAKDOWN



ILLUSTRATED PARTS BREAKDOWN

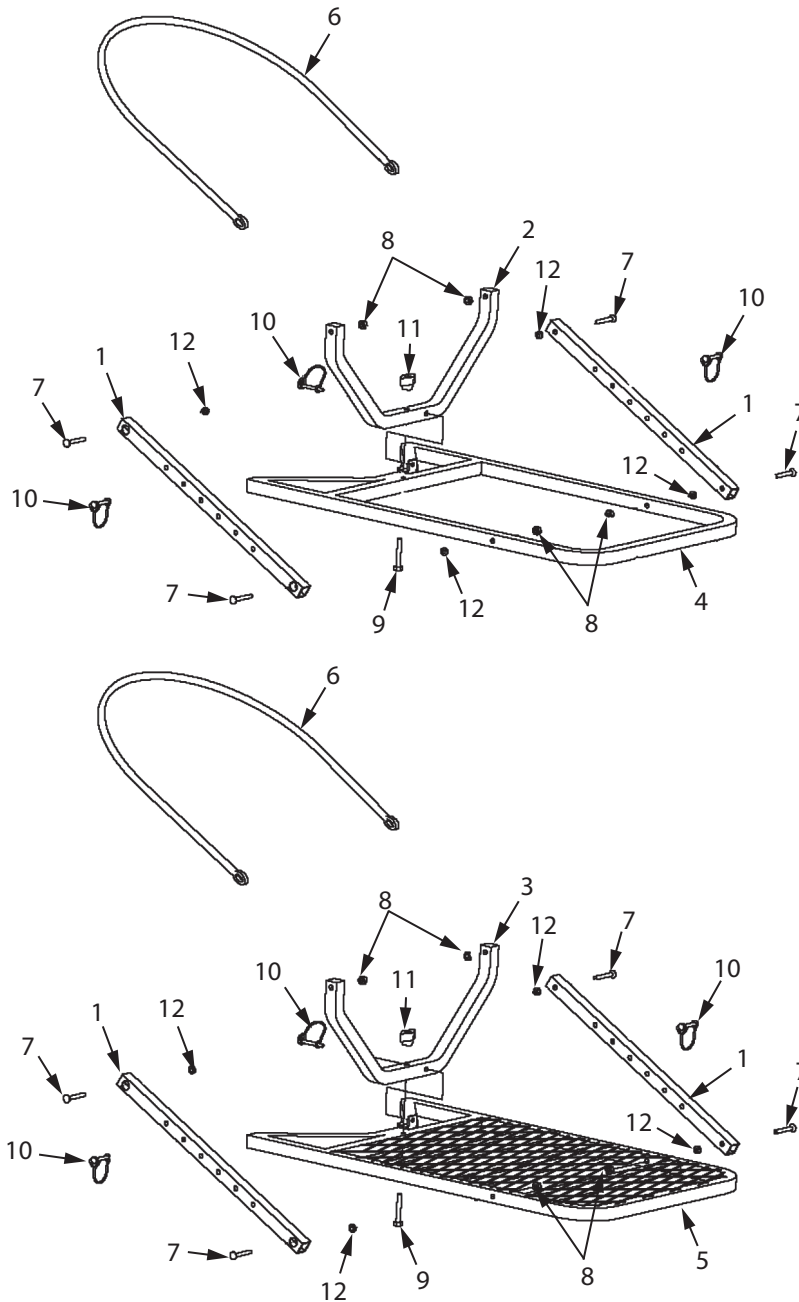

ILLUSTRATED PARTS BREAKDOWN

ITEM #	PART #	DESCRIPTION	QTY
1	MK019-9001	CABLE SUPPORT TUBE	4
2	MK019-9002	SEAT FRAME SUPPORT	1
3	MK019-9003	FOOT PLATFORM SUPPORT	1
4	MK019-9100	SEAT FRAME	1
5	MK019-9200	FOOT PLATFORM	1
6	MK019-9300	STEEL CABLE	2
7	28080402B	M8 X 40MM BOLT	8
8	41080002B	M8 LOCK NUT	8
9	10080703B	M8 X 70MM HEX HEAD BOLT	2
10	HE032-2702	SPRING LOCK PIN	6
11	91080012B	M8 HAND KNOB	2
12	31080002B	M8 POLYMER WASHER	8
13*	MK019-9411	FOOT STRAP PACK (2 CAM BUCKLES, 1 STRAP)	1
14*	MK019-9402	SHOULDER HARNESS STRAP	2
15*	MK019-9407	CAM LOCK STRAP	2
16*	MK019-9404	ROPE	1
17*	MK019-9405	BUNGEE CORD	1
18*	MK019-9403	PACK STRAP	2
19	02-BHFAS1-010	SAFETY HARNESS / FALL ARREST	1
20	99-SAFE09-DVD	SAFE TREESTAND HUNTING DVD	1
21*	MK014-4201	SEAT AND BACK REST CUSHION	1
22*	MK019-9406	ARM REST / SHOOTING RAIL COVER	3
23	21518-REV0	INSTRUCTION MANUAL	1
* ITEM NOT ILLUSTRATED			

Single User Maximum Field Rating - 300 lb

(This is the maximum combined total weight of the user, their clothing, and gear while on the platform and/or seat) No more than one person should occupy any part of this stand at any time.

Tree Diameter Range - 8" to 20"

(Select only strong, healthy trees that are straight with no loose bark)

LIMITED WARRANTY POLICY

Limited Warranty Periods

- **Hunting Products:** 1 Year (12 months) from date of purchase.
- **Sub-component Items:** Many sub-component items are warranted separately by the respective manufactures and are covered by warranty of their manufacturer. The sub-components original manufactures product warranty supersedes and takes precedence over this limited warranty policy.

NOTE: ALL WARRANTY CLAIMS MUST BE PREAPPROVED BY THE MANUFACTURER (THE COMPANY) TO BE VALID.

Products are warranted to be free of defects in materials and/or workmanship for the warranty period. Under this limited warranty, the Company shall be limited to repairing or replacing, at its option, for the warranty period, those parts returned to the factory, freight prepaid, which in the opinion of the Company shall prove to be defective in materials or workmanship, under normal use and service. This warranty will not apply unless the product is installed, used and maintained in accordance with the Manufacturers installation, operation and maintenance instructions.

This warranty applies to the **ORIGINAL** purchaser only, and is non-transferable. The Company warrants the products to be free of defects in material and workmanship but, does not cover normal maintenance or adjustments, damage or malfunction caused by: improper handling, installation, abuse, misuse, negligence, carelessness of operation or normal wear and tear. In addition, this warranty does not cover equipment when repairs or alterations have been made or attempted without the express written consent of the company. Product repairs not covered by the warranty, and product updates, will be provided at the prevailing rate.

The Company is not responsible for damage caused by accident, negligence, abuse, overloading, misapplication, or misuse of the products. It is solely the purchaser's responsibility to determine the suitability of these products for the particular application. **Limitations:** All other obligations or liabilities, including incidental or consequential damages or contingent liabilities arising out of the failure of any parts to operate properly are hereby excluded, including but not limited to any damages resulting from loss of use, inconvenience, loss of time, commercial loss, or any other type of damages general or specific, foreseen or unforeseen, unless applicable state law provides otherwise.

THIS WARRANTY IS EXCLUSIVE AND IS LIEU OF ALL OTHER WARRANTIES EXPRESSED OR IMPLIED INCLUDING ANY IMPLIED WARRANTY OR MERCHANTABILITY OR ANY IMPLIED WARRANTY OF FITNESS FROM A PARTICULAR PURPOSE, AND ALL SUCH IMPLIED WARRANTIES ARE EXPRESSLY EXCLUDED.

THE REMEDIES DESCRIBED ARE EXCLUSIVE AND IN NO EVENT SHALL THE COMPANY, NOR ANY SALES AGENT OR OTHER COMPANIES AFFILIATED WITH IT OR THEM, BE LIABLE FOR SPECIAL CONSEQUENTIAL OR INCIDENTAL DAMAGES FOR THE BREACH OF OR DELAY IN PERFORMANCE OF THIS WARRANTY. THIS INCLUDES, BUT IS NOT LIMITED TO, LOSS OF PROFIT, RENTAL OR SUBSTITUTE EQUIPMENT OR OTHER COMMERCIAL LOSS.

This warranty shall be governed by the laws of the State of Texas, and shall be subject to the exclusive jurisdiction of the Court in the State of Texas in the County of Tarrant.

RETURNS: Products may not be returned without written approval (Return Material Authorization) from the Company.

Warranty Rev04152008
Direct Outdoor Products, LLC

