

Turkey

Mount Kit Instructions



Includes:

- 1 – 1 $\frac{1}{8}$ " Screw for Assembly
- 2 – $\frac{3}{4}$ " Steel Screws for Assembly
- 1 – Baltic Birch Hanger
- 1 – Solid Oak Turkey Plaque



1. To remove the tail from the turkey, close the fan and follow the tail feathers to the base. You will feel a triangular shaped piece of meat beneath the skin that moves with the tail. With a sharp knife, detach the base from where it attaches to the body. (Tip: It is better to leave too many of the smaller feathers on the tail than not enough. The tail can always be trimmed later)



2. Lay the tail on a flat hard surface and carefully scrape the meat from the feather quills. Do not remove the connective tissue that holds the quills in place. Take your time and remove as much meat as possible. (Tip: If you have secured more of the smaller feathers than you needed, now is the time to trim them off)



3. Apply borax to the fleshed area. Rub into the skin and around the feather quills. Do not skimp on the borax, more is better. (Tip: borax is readily available at grocery stores in the laundry aisle.)

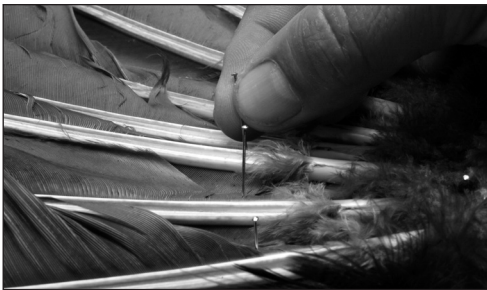

4. Fan the tail out on a large piece of cardboard so that it creates a half circle. Place a small nail or pin in front of each feather to hold it in the desired position. (Tip: If necessary, add more borax to make sure you have penetrated every nook and cranny between the quills.)



5. When you are satisfied with the result, place another piece of cardboard on top of the fan and secure it in place with tape for 7-9 days until it is dry.

- 5 $\frac{1}{2}$. For a faster result, auto body filler (bondo) can be used. Instead of covering with a second piece of cardboard, brush away any excess borax and mix a sufficient amount of bondo to cover the exposed quills. Apply the mixed bondo onto the quills. Use a putty knife to press the bondo between the quills. The bondo will set within a few minutes so you have to work quickly.

6. Detach the beard from the body with a sharp knife. Scrape any extra meat from the base of the beard and liberally rub borax on the fleshy part. Let dry for 7-9 days.

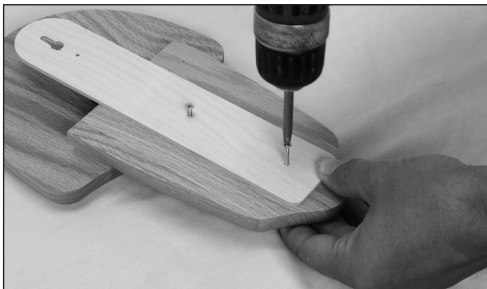

7. Remove the turkey display kit from the box. Loosely attach the Birch hanger to the oak assembly (as shown above) using the two $\frac{3}{4}$ " steel screws provided.



8. Slide tail into position.

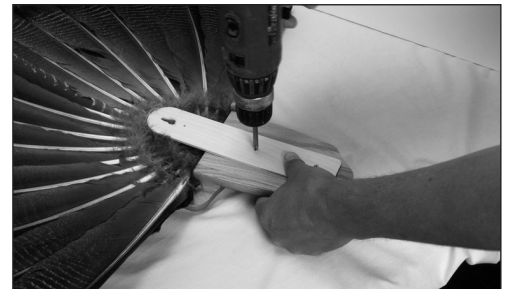

9. When tail is centered and in position tighten the steel screws holding the Birch hanger.



- 9 $\frac{1}{2}$. (Optional) Screw the 15/8" screw through the predrilled hole in the hanger, and completely through the base of the tail.



10. Place a small amount of clear or hot glue on the end of the beard and place into beard slot as shown



11. If desired, spurs can be mounted to either side of the beard as shown, using a spot of clear or hot glue.