



A4

THE SOUND OF SILENCE

OWNERS MANUAL

ASSEMBLY, OPERATION, USE AND MAINTENANCE

CAMXTM
CROSSBOWS

TABLE OF CONTENTS

INTRODUCTION	3
CROSSBOW SAFETY	5
CROSSBOW ANATOMY	11
ASSEMBLY	12
WISHBONE™ QUIVER	19
COMFORTEK™ STOCK ADJUSTMENT	22
COCKING THE CROSSBOW	23
UNCOCKING THE CROSSBOW	30
LOADING YOUR CROSSBOW	35
SHOOTING YOUR CROSSBOW	38
SHOOTING TIPS	40
SIGHTING AND SCOPE ADJUSTMENTS	41
CHOOSING THE RIGHT ARROW	45
CROSSBOW TARGETS	48
CARE, MAINTENANCE, STORAGE AND SERVICE	50
LIMITED LIFETIME WARRANTY:	53

ANSI STANDARDS

THIS OWNER'S MANUAL CONTAINS SAFETY INSTRUCTIONS PRECEDED BY THE FOLLOWING AMERICAN NATIONAL STANDARDS INSTITUTE APPROVED SIGNAL WORDS. [ANSI STANDARDS]

THESE SIGNAL WORDS WILL ALERT YOU TO SPECIFIC LEVELS OF HAZARD



OTHER WARNINGS:



Continue to next step



You **MUST** read



Wrong or dangerous



Correct or safe

INTRODUCTION

WELCOME: You are now the proud owner of one of America's finest hunting crossbows. CAMX Crossbows are designed, engineered, tested, and manufactured in the United States of America and are recognized through the shooting and hunting industry. Rugged, dependable, and safe, each CAMX Crossbow utilizes the finest materials and latest manufacturing processes to ensure their performance. With reasonable care, your new CAMX Crossbow will provide you with years of pleasure and service.



BEFORE YOU BEGIN ASSEMBLY OR OPERATION, READ THIS MANUAL THOROUGHLY. WITHOUT PROPER WORKING KNOWLEDGE AND INSTRUCTION, YOU COULD DAMAGE YOUR CROSSBOW AND/OR CAUSE INJURY TO YOURSELF AND/OR OTHERS.

If any part of this manual is unclear, contact CAMX Crossbows at **[877] 503-5483** prior to shooting. We are here to help you and to ensure your safety while shooting. When you have read this manual thoroughly and understand it completely, be sure to save it for future reference.

TESTING AND ASSURANCE

Rest assured that every CAMX Crossbow has been thoroughly inspected before leaving the factory and has met or exceeded our stringent quality and performance standards. Your crossbow, first and foremost, has been deemed to be in SAFE working order.

CAMX PEAK Performance standards also ensure that your crossbow model has been assembled, weighed, chronographed, and test shot for accuracy. You can take great satisfaction in knowing that your crossbow will perform as advertised.

Every effort has been made to ensure that all product photographs, drawings or illustrations, and descriptions in this manual are accurate. With our continued effort to provide you with the best products possible, revisions in design or materials may result without notice. CAMX Outdoors, LLC., reserves the right to change or modify information and/or specifications contained in this manual without notice. Please visit us at **www.camxcrossbows.com** for updated information.

NOTE: This manual may service several CAMX crossbow models. Variations may appear and exist between your particular crossbow model and those shown throughout.

CAMX Crossbows shall not be liable for technical or editorial mistakes or errors in this manual nor shall it be liable for damages, incidental or consequential, resulting from your use of the information contained in this manual.

This owner's manual contains proprietary and confidential information and is copyrighted. All rights reserved. No portions of this manual are to be copied or reproduced without the written consent of CAMX Crossbows.

CROSSBOW SAFETY



DANGER

IMPROPER USE OF THIS CROSSBOW CAN RESULT IN SERIOUS INJURY TO THE USER AND OR OTHERS.



WARNING

DO NOT ASSEMBLE OR SHOOT YOUR CROSSBOW UNTIL YOU HAVE READ THIS ENTIRE MANUAL AND ARE FAMILIAR WITH ITS SAFE OPERATION. IF ANY PART OF THIS MANUAL IS UNCLEAR, OR CONFUSING TO YOU, CONTACT CAMX CROSSBOWS PRIOR TO USE.



NOTICE

PRIOR TO HUNTING, CONSULT YOUR LOCAL GAME OR WILDLIFE AGENCY REGARDING THE CURRENT RULES AND REGULATIONS GOVERNING CROSSBOW USE IN YOUR STATE.



DANGER

SHOOTING SAFETY

Above all else, know that your crossbow is a high performance weapon, capable of taking the world's largest game. ALWAYS treat and handle your crossbow with the same care and concern as you would a loaded firearm.

SAFETY PRECAUTIONS



BEFORE YOU SHOOT YOUR CROSSBOW, YOU MUST READ THE SAFETY AND OPERATION INSTRUCTIONS IN THIS MANUAL.



NEVER handle your cocked crossbow by **grabbing or holding it by the limbs, string, or barrel.** Handle your crossbow keeping your hand, fingers and thumb below the Thumbsaver™ guard. CAMX has designed a stock handle grip, a pistol grip, and a vented forearm grip into its design for proper and safe handling of your crossbow.



BEFORE SHOOTING ENSURE THAT THE CROSSBOW LIMBS AND STRINGS ARE FREE OF OBSTRUCTIONS: Make sure the crossbow is clear from striking obstacles like tree limbs. It can greatly affect the accuracy of the arrow, may result in damage to the crossbow, and/or cause bodily injury to you or others.

NEVER rely on the mechanical safety alone. **ALWAYS** point your crossbow down, and away from any object, target or animal you do not intend to shoot.

NEVER move the safety to the FIRE position until you are ready to take a shot at your target or an animal.

ALWAYS keep your finger off of the trigger until you are ready to shoot and have made the decision that it is safe to shoot.

ALWAYS make certain that others are behind you when you are shooting your crossbow. Should the limb, string or cables break, you may seriously injure a person standing close to you.



BEFORE EACH SHOOTING SESSION, ALWAYS INSPECT YOUR ARROWS PRIOR TO USE:

Check that the carbon shaft is not cracked or damaged in anyway. Check that all fletchings/vanes, nocks, and inserts are secure, intact, and not damaged. Replace any damaged components at first signs of wear.

NEVER pre-load your trigger prior to shooting your crossbow. The trigger is highly engineered and is designed to operate without the need to preload it.

NEVER shoot an arrow that is less than 18" long or less than 390 total grains of weight.

NEVER hand your crossbow to another person when it is loaded with an arrow.

NEVER leave your crossbow unsupervised, whether it is cocked or uncocked. Treat it as if it were a loaded firearm.

NEVER walk around or stalk game with an arrow loaded in your crossbow.

ALWAYS wear safety glasses when shooting your crossbow to protect your eyes.

ALWAYS identify and be certain of your target and beyond, whether it be an animal or practice target, before you pull the trigger. An arrow can travel well past your intended target and still be lethal or cause serious damage or personal injury.

NEVER shoot your crossbow if you observe that the string or cables have a cut or broken strand.

ALWAYS practice shooting in an open and well lit space that has a clear and unobstructed view of your target.

ALWAYS use a practice target that is designed and recommended by its manufacturer for use with crossbows.

ALWAYS be certain that the safety is in the safe position when carrying a cocked crossbow, even if it is not loaded.

NEVER consume drugs or alcohol before or while using your crossbow. Your vision, coordination, and judgment may be impaired enough to risk bodily injury, or even death, to you or others.

NEVER attempt to cock your crossbow while in a treestand. It is much safer to cock your crossbow at the base of the tree, then hoist your crossbow up using a rope.

ALWAYS maintain your crossbow properly and keep it in its safe working condition to achieve peak performance and offer you years of safe and enjoyable use.

NEVER Store your crossbow for extended periods of time in a closed vehicle where the interior temperatures can exceed 100 degrees.

ALWAYS maintain your crossbows strings and cables.



MAKE SURE the person you hand your crossbow to is familiar with the safety recommendations in this owner's manual. This is YOUR responsibility as the crossbow owner.



NEVER ATTEMPT TO TRANSPORT YOUR CROSSBOW WHILE COCKED OR LOADED.

NEVER DRY FIRE THE CROSSBOW OR SHOOT IT WITHOUT AN ARROW.

ALWAYS keep sharp broadheads covered when hunting or transporting and away from yourself and others as well as your crossbow's strings and cables. Remember, broadheads are razor sharp and will cut on contact.



A4 CROSSBOW ANATOMY



ASSEMBLY

Your new CAMX crossbow was tested and shot at the factory, however, some basic assembly is required before heading afield. Find a flat, spacious work area and devote your full attention to the contents of this entire manual. Conduct a review of all the components prior to assembly to ensure all items have been included. Should any items be missing, please contact us at once.

Your base package should contain the following items [See Figure 1]:

1. Stock Assembly with ARC™ Crossbow Scope
2. Bow Unit with Gripper™ Foot Stirrup
3. Wishbone™ 4 Arrow Quiver
4. 4 ACCUSPINE™ Arrows
5. Rope cocking sled
6. Hardware Pack



Figure 1

The hardware packet included with your crossbow will contain your bow's mounting bolt, 2 cable savers, hex key and Comfortek™ Stock Spacers with mounting screws. [One cable saver is needed for assembly, the second is an extra.]

NOTE: This manual may service several CAMX crossbow models. Variations may appear and exist between your particular crossbow model and those shown throughout.

NOW THAT THE CONTENTS HAVE BEEN CHECKED AND ALL ITEMS HAVE BEEN SUPPLIED, LET'S BEGIN THE SIMPLE AND BRIEF ASSEMBLY.

Locate the red cable saver. Orient the bow so that the cables are closest to you and the cocking stirrup furthest away. Make sure the bow is facing up, as if it was in the shooting position.

[See Figure 2]

Now position the cable saver so that the smooth curved section faces up and the three blades face down. The cable saver should be oriented so that the small molded in arrow symbol is on top and facing away from you or toward the front of the bow.



Figure 2



Figure 3

Insert the middle blade on the bottom of the cable saver between the cables. The cable saver should be positioned so that the cables cross one another on the left side of the cable saver from the shooters perspective. [See Figure 3]

Next begin to insert the cables and cable saver into the cable slot by aligning the cable saver with the underside of the flight groove in the barrel. The cable saver should be oriented in a manner that the concave side with the arrow symbol is up and mates with the corresponding convex shape at the bottom of the flight groove. [See Figure 4]

NOTE: WITH THE STRING RESTING ON THE BARREL IT WILL BE NECESSARY TO APPLY A SMALL AMOUNT OF DOWNWARD PRESSURE TO THE CABLES AND CABLE SAVER TO ALIGN THE CABLE SAVER IN THE CABLE SLOT.

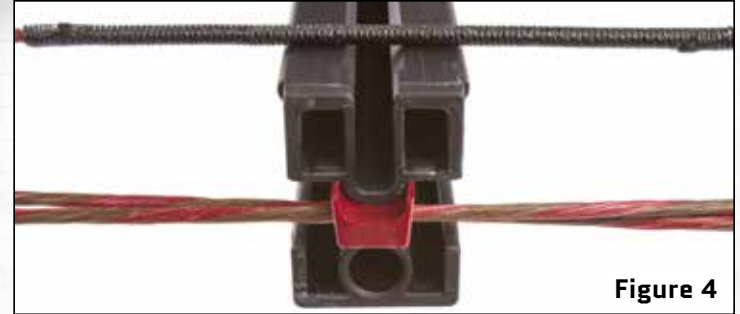

Figure 4



Figure 5

Continue to slide the bow unit towards the front of the barrel, string on top of the barrel and cables and cable saver positioned in the cable slot.

[See Figure 5]

As the bow unit approaches the front of the barrel, align the barrel with the cutout in the rear of the riser. Upon close inspection of the riser, you will note two alignment blocks. The blocks in the rear of the riser must align with the corresponding recesses on each side of the flight groove in the barrel. Slide the bow unit onto the barrel until it is fully seated up against the barrel. **[See Figure 6]**

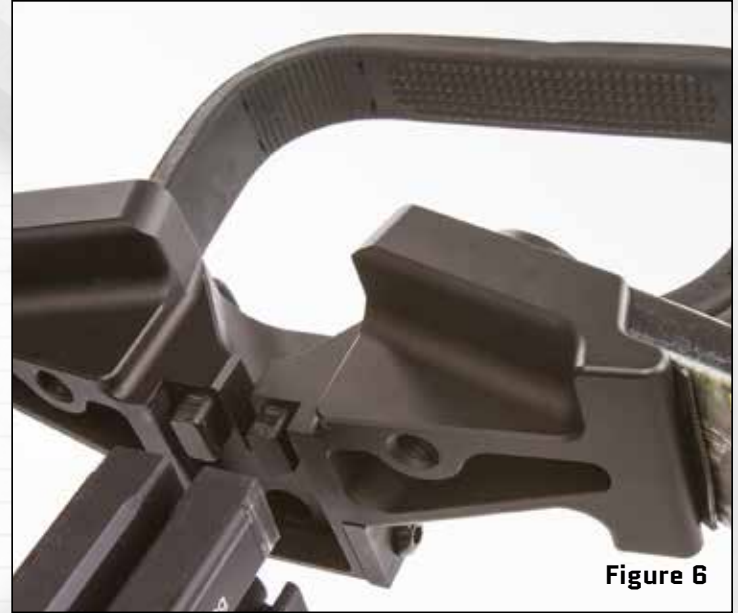

Figure 6

NOTE: The barrel to riser fit is precision machined with minimal tolerance. A small amount of effort and patience is needed to ensure proper alignment and that the barrel is properly seated. [See Figure 7]

Secure the bow unit to the barrel and stock assembly with the included bow mounting bolt. Insert the 1/4"x 20 x 2 3/4" shoulder bolt into the hole in the front of the riser and align with the counter bored hole in the barrel. [See Figure 7]

This is a precision fit and there is minimal clearance. As such you will find that it is necessary to apply a downward force against the riser/stirrup to overcome the tension of the cables and string. This is best achieved by pulling down on the stirrup to close the gap at the bottom of the barrel and riser as you tighten the shoulder bolt. [See Figure 8]



Figure 7



Figure 8

Note: You may also find it easier to place the butt of the stock down on the ground. With the crossbow upside down to you, push the top of the stirrup up against a wall or table for added leverage.

Securely tighten the mounting bolt with the supplied 3/16" Hex key [Figure 9]

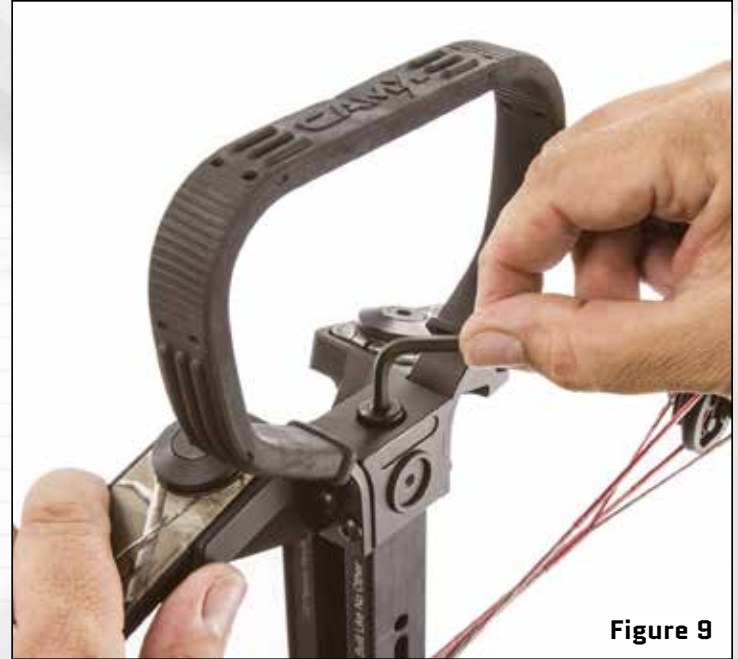

Figure 9

You have now successfully completed assembly of the crossbow. Before heading afield, visually inspect the crossbow and ensure all fasteners are tight and all components are secure. [Figure 10]



GO

Figure 10



WARNING

Please continue to take a moment to finish reading this operations manual to better understand the safe operation and use of your new CAMX crossbow.

As always, if you have any questions or are uncertain of the assembly or operation of your crossbow please contact CAMX Crossbows immediately at [877] 503-5483.

WISHBONE™ QUIVER

The Wishbone™ quiver included in your Peak Performance™ system is fully assembled and ready for right hand installation.



Figure 11

To install, locate the threaded mounting hole on the underside of the barrel, approximately midway between the riser and the forearm of the stock.

Thread the captured mounting bolt in the quiver's arm into the hole while inserting the alignment pins on the quiver arm into the holes provided in the barrel above and below the threaded hole. Tighten knob firmly.

[See Figure 11]

To load the Wishbone™ Quiver, simply lay arrows into the openings across the dual arrow spreaders with broadhead fully enclosed by the quiver cup. Press the arrow into the top spreader first, then the bottom. To remove arrows, reverse the process. The two rows of arrow spreaders eliminate the need for foam in the quiver cup allowing the use of mechanical broadheads and will not dull fixed blade heads.

Also, the dual arrow spreaders hold arrows securely while permitting easy and quiet removal. To remove the quiver for transportation, unscrew the locking knob. Once removed, place the quiver anywhere without fear of losing the knob as it is held against the quiver frame with a retaining ring.



WARNING

Take great care in handling broadhead tipped arrows. When installing broadhead tipped arrows into the Wishbone™ quiver, be sure to position the broadhead fully into the quiver cup to provide complete protection.

After removing an arrow for loading, take great care to avoid cutting your crossbow's cables or strings with a razor sharp broadhead. [See Figure 12]

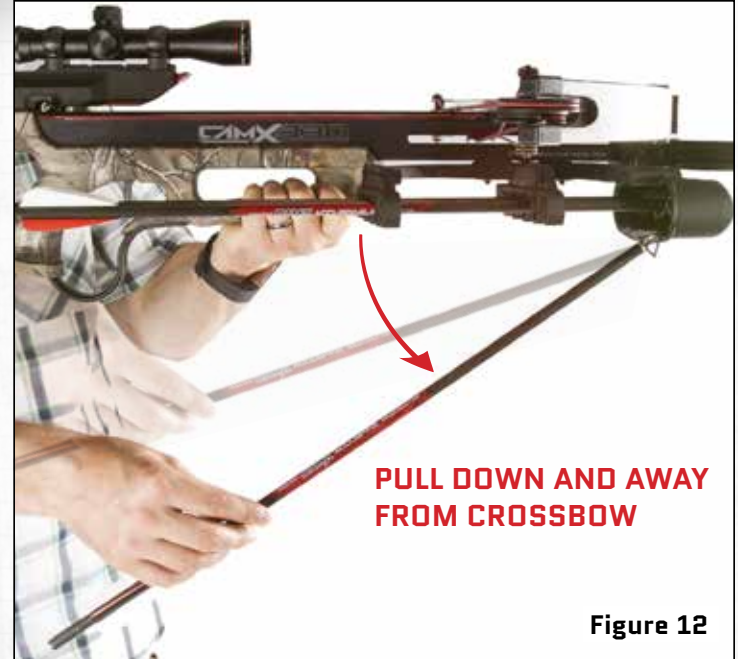

Figure 12

LEFT HAND CONVERSION

Your Wishbone™ quiver easily converts to left hand orientation. A small Phillips head screwdriver will be required to perform the operation.

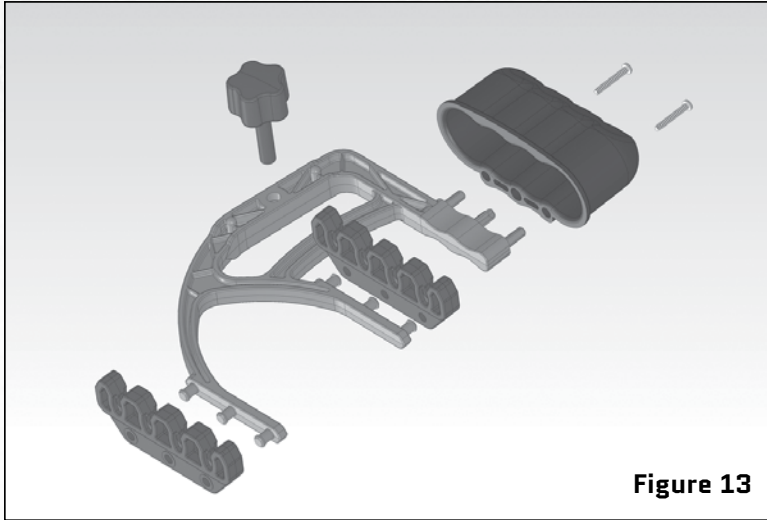

Figure 13

Begin by holding the quiver arms securely. Remove the retaining ring on the backside of the knob that holds it against the quiver frame. With a small screwdriver blade or knife you should easily be able to pry it away from the threaded insert. Once the retaining ring has been removed, remove the knob and reinstall it through the opposite side of the quiver frame. Push the knob in all the way against the quiver frame and reinstall the retaining ring in the groove of the threaded insert of the knob. The retaining ring should push past the groove and snap into place.

The final step is to reverse the broadhead cup. Remove the two Phillips head screws, pull the cup from its mounting posts and reverse the cup 180°. Re-install the Phillips head screws securely.
[See figure 13]

Nothing breeds confidence like a well fitted stock. Just raise, aim and squeeze. No head wiggling or struggling to get a clear steady sight picture. The Comfortek™ stock of your CAMX features an adjustable spacer system which permits custom fitting the LOP (length of pull) from 13 1/4" to 15". Utilize this feature to position the trigger comfortably, and to position the scope for perfect eye relief. **[See Figure 14]**

The Comfortek™ adjustment system includes a butt plate, one (1) 1/2 "spacer (installed), two (2) 1/4" spacers and one (1) 3/4" spacer with mounting screws for any combination. To shorten or lengthen the stock, remove the butt plate with a Phillips screwdriver and add or subtract spacers for the proper fit.

Once the proper spacer combination is determined, select from the included mounting screws the pair that protrudes approximately 1/2" from the butt plate and selected spacers. Next, simply re-attach.

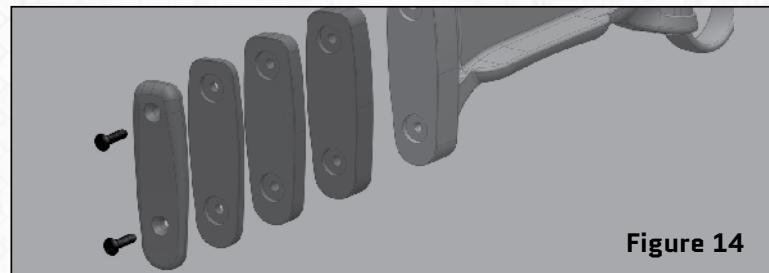

Figure 14

HINT: Keep your stock fit perfect regardless of the season. Utilize the adjustment feature of the Comfortek throughout the year i.e. longer for summertime practice wearing light clothing, to shorter length setting for winter hunting while donning bulky insulated wear.

COCKING THE CROSSBOW

CAMX has designed the Slider rope cocking aid for use with your new A4 crossbow. The Slider is the only rope cocking aid provided and authorized for use with the CAMX A4. Use of any other rope style cocker may damage the “Thumbsaver™” guards and/or prevent proper and safe cocking of your crossbow. Attempting to cock the A4 without the included Slider cocking aid will void the manufacturer’s warranty and could result in serious bodily injury and /or damage to the crossbow.



The rope or overall length of your Slider cocking aid has been properly adjusted and set at the factory. It may appear that the rope is too short but this is done to allow the sled to stay attached to the string when the crossbow is uncocked for storage, transportation and to prevent loss.

You may find it necessary to slightly draw the crossbow string in order to get the string grooves on the underside of the sled to engage the string. The slight amount of tension between the sled, crossbow string and rope being engaged around the cocking groove in the stock will keep the Slider in place.

INSTRUCTIONS FOR USE

Point the crossbow down into the cocking position by placing the cocking stirrup on the ground. Place one foot fully and securely into the stirrup and apply a downward force as necessary with your foot to hold the crossbow down resisting any upward force.

[See Figure 15]



Figure 15

Pull the rope from between the rollers on the sled all the way out until the handles are touching the sides of sled. **[See Figure 16]**

Holding the rope at the rear while the sled and handles hang below, drape or loop the cocking rope over top and behind the scope. Place the center rope section into the cocking aid groove located in the plastic stock at the rear of the Monobloc™ scope base. **[See Figure 17]**



Figure 16



Figure 17

Make sure the cocking sled is properly positioned and oriented with the top up. For reference the bottom of the sled has the three blades or runners and will sit directly on top of the barrel. The two outer runners depress the Thumbsavers and ride along the outside of the Thumbsavers and barrel. The runners also incorporate the receiving groove for the crossbow string at the rear. The center blade rides down into the arrow flight groove in the barrel.

While bending over the stock to attach the cocking sled to the crossbow string keep tension on the rope to ensure it doesn't jump from the cocking aid groove in the stock. As you begin to attach the sled to the string make sure that the sled begins to fold the Thumbsavers down along the sides of the barrel.

You may find it necessary to pull up slightly on the crossbow string to ensure that the crossbow string engages both string grooves located at the rear of the outer runners on the bottom of the sled.

[See Figure 18]



Figure 18

The “T” handles should be at rest up against each side of the cocking sled. Visually check to ensure the rope is still in place in the cocking aid groove located behind the Monoblock™ scope mount and that the rope has a clear path to the sled. Make sure that the rope is not caught on anything like the scope or Thumbsavers™ on either side. Grasp each T handle firmly. **[See Figure 19]**



Figure 19

Pull evenly and smoothly on the T-handles, keeping the crossbow string flat against the barrel while simultaneously standing in an upright position. The cocking motion used with the Slider rope cocker will resemble that of rowing a boat. **[See Figure 20]**



Figure 20

Continue pulling on the T-handles and raise the crossbow string into the opening of the Monoblock™ scope base, pull fully to the rear until string passes over the string latch and the safety moves to the SAFE position. Relax pulling tension slightly to ensure the string latch in the trigger mechanism has securely captured and is holding the crossbow string.

To remove the Slider cocking aid from the crossbow string let go of the T-handles, grasp the sides of the sled where the rope passes through the roller and push the sled forward or down. Once the cocking sled is free from the PAR arrow retainer, Monoblock™ and crossbow string the Thumbsaver™ guards should automatically return to their upright position. Visually inspect to ensure the safety is in the SAFE position and that the Thumbsavers™ are deployed in the upright position.



DANGER

After cocking is complete, place the rope cocker in a pocket or safely away from the crossbow when shooting to eliminate the possibility of injury or damage to the crossbow in the event of tangling or interference between the rope cocker and crossbow during firing. [See Figure 21]

DO NOT PLACE
ROPE COCKER
AROUND NECK



Figure 21

UNCOCKING THE CROSSBOW

UNCOCKING: STANDARD METHOD

After a hunt or shooting session, it is wise to unload and un-cock the crossbow as soon as possible.

The safest and simplest method is to discharge a practice point tipped arrow down into soft earth, free of rocks or other debris when afield and the use of a suitable crossbow target is unavailable. There is some risk as it is possible that your arrow may get damaged by unforeseen objects. Some hunters carry a used practice arrow with them for unloading purposes.

Small discharge or unloading targets rated for crossbows are also available by numerous target makers. [See Figure 22 & 23]



Figure 22



Figure 23

UNCOCKING THE CROSSBOW

UNCOCKING: USING THE A4 SLIDER ROPE COCKING AID



WARNING

This method of un-cocking should only be performed by adults possessing at least average strength and dexterity with clear understanding of the operation.

If you possess any doubt or uncertainty that you cannot perform the outlined functions, DO NOT ATTEMPT THIS METHOD. Refer to the instructions for UNCOCKING STANDARD METHOD listed previously on page 30.

WARNING

Your CAMX crossbow should always be uncocked at the end of you hunt. Never store your crossbow in the cocked position. Storing your crossbow cocked can result in damage to the bow and will not be covered by warranty.

First remove the arrow and ensure that the safety is in the SAFE position. Once the arrow is removed the Anti-Dry-Fire should prevent the safety from being pushed into the FIRE position. An arrow is required to be properly loaded and seated against the string to allow the safety to move from SAFE to FIRE.

Position the crossbow into the cocking position, cocking stirrup down and resting on the ground. Place one foot securely into the stirrup.

Begin by attaching the Slider cocking sled to the cocked crossbow string. Pull the cocking rope out from between the legs of the sled and rollers. Let the slack or loop hang down in front of the barrel and scope and slide the sled into the opening between the top of the barrel and Monoblock™. Ensure the sled is oriented correctly with the bottom facing down against the barrel. You will need to push the sled down on top of the barrel as the outer runners fold the Thumbsavers™ down and the center blade enters the flight groove. As you continue sliding the sled between the top of the barrel and the Monoblock™ lift the rear legs of the sled up and over the cocked crossbow string then back down so that the string groove in the outer runners engage the crossbow string. Once the sled is slid back far enough the PAR arrow retainer should hold the sled in place on the barrel. **[See Figure 24]**



Figure 24

Lift the cocking rope up and over the scope and position it in the cocking groove located in the stock just behind the Monoblock scope mount. Reduce all slack by bring both handles together and holding them both in one hand and draw upwards. Once the slack is removed continue applying upward force so as to draw the cocking sled up enough so that it fully supports the crossbow string across the sled and engages the Anti-Dry-Fire mechanism. Once the sled is pulled into the correct position and pressure is maintained you will be able with your other hand to reach between the cocking rope and scope mount to push the safety into the FIRE position. **[See Figure 25]**



Once the safety is in the FIRE position, grasp just one of the T-handles with your dominate hand and pull all the rope through as the other handle slides down and against the cocking sled.

Continue to pull on the T-handle with your dominate hand so there is no slack in the rope. With your foot still securely positioned in the cocking stirrup, pull firmly up on the T-handle so that the sled and crossbow string take the load off the string latch in the trigger. This prevents the string from jumping or firing onto the sled when you pull the trigger. Failure to lift the string up fully onto the sled can cause a miniature dryfire which is harmful to the crossbow.

Be careful not to pull up too hard and high or you will reset the safety back into the SAFE position and have to repeat the process again. With your weak hand or opposite hand of the one pulling up on the T-handle, reach down and pull the trigger while continuing to hold the crossbow load as you ease the handle down allowing the string and cocking sled to slowly move forward. Do not let go of the T-handle at any time until the crossbow string is fully lowered to its brace or uncocked starting position. **[See Figure 26]**



Figure 26

NOTE: As the cocking sled is lowered while uncocking, the cocking rope runs across the cocking groove and will remove the camo finish inside the cocking groove in the stock. This is considered normal and customary wear and is not a warranty covered item or occurrence. **[See Figure 27]**

For additional information and an instructional video on uncocking your A4 crossbow please visit the CAMX website: www.camxcrossbows.com



Figure 27

LOADING YOUR CROSSBOW

ONCE THE CROSSBOW IS COCKED, VERIFY THE SAFETY IS FULLY IN THE "SAFE" POSITION.



WARNING

Only when loading an arrow, make sure your hands, finger and thumb remain above the string path.

Slide the arrow back and under the PAR™ arrow retainer until the rear of the arrow [aluminum flat nock] rest fully against the crossbow string. [See Figure 28]



Figure 28

If the arrow is not slid all the way back against the string then it will not disengage the Anti-Dry-Fire device and prevent you from moving the safety into the FIRE position. **[See Figure 29]**



Figure 29

WARNING

The Anti-Dry-Fire is an internal safety feature which prevents the user from accidentally firing the crossbow without an arrow properly loaded. A dryfire or accidental discharge of the crossbow without a loaded arrow could result in serious bodily harm to the user and/or any bystanders and will damage the crossbow. Dryfiring or making any attempt to by-pass or alter the Anti-Dry-Fire mechanism will void all manufactures warranties and potential liability.

Push on the arrow to ensure solid contact between the arrow and the barrel. You may now visually confirm proper loading by verifying that the rear of the vane is positioned at or just behind the LOAD line located near the front, on both sides of the Monobloc™ Scope Base. [See Figures 30, 31, 32]



Figure 30



Figure 31

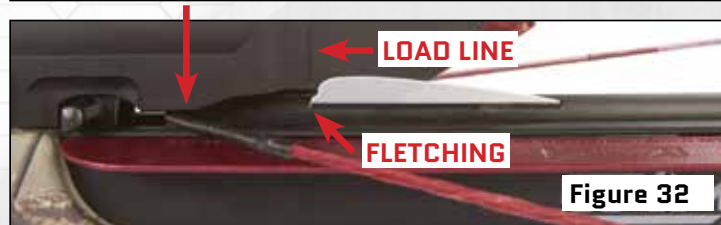

Figure 32

SHOOTING YOUR CROSSBOW

With the crossbow pointed downrange, shoulder it placing your front hand securely and comfortably on the forearm of the crossbow out of harms way, and with thumb and fingers positioned safely below the Thumbsaver™ guards. [See figure 33]



Figure 33

Your cheek should rest comfortably on the cheek piece of the stock with your dominant eye positioned directly in line and 1 1/2" to 2" away from the scope's eyepiece. Move the safety forward to the FIRE position.



If you are unable to move the safety to the FIRE position, your arrow has not been properly loaded. Check figure 30, 31, 32 again to ensure the arrow is properly seated against the string, past the load line. Take careful aim while holding the crossbow securely and keeping bow limbs parallel to the ground. Press the trigger gently to the rear until the crossbow fires. Continue to aim until the arrow has reached the target.



DANGER

THESE ARE PICTURES OF WRONG FOREHAND PLACEMENT

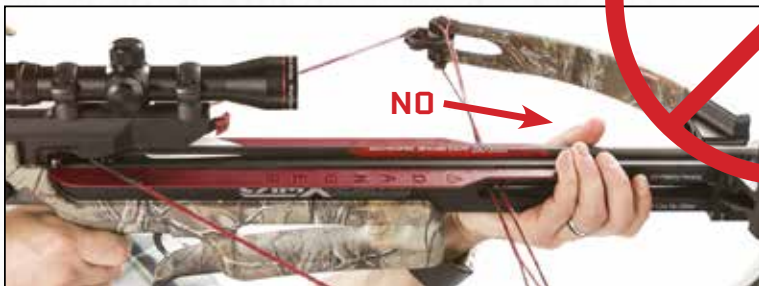

SHOOTING TIPS

Top crossbow shooters have several things in common. During practice sessions, they have bred consistency into their shooting technique. They take all of the following into consideration: consistent straight cocking procedures; mounting the bow with consistent cheek and stock pressure; placement of their trigger finger on the trigger, amount of time to execute the shot, keeping the bow parallel to the ground, consistent breathing and a rock-steady follow through.

Developing sound shooting habits during the summer will reap huge benefits in the fall. Remember, it is much more important to execute good shots than to aim good shots. Aim and hold as steady as possible, control your breathing, but expect some movement of the sight.

After all, you are human. Just squeeze the trigger smoothly, not anticipating the shot and always keep aiming until after the arrow reaches the target. Many top shooters ensure their follow through by watching the arrow fly en route to the target through their optics.

By following these simple tips, and a little practice, you will soon be amazing yourself at the accuracy achieved with your CAMX system.

SIGHTING AND SCOPE ADJUSTMENTS

Your CAMX crossbow scope has been pre-mounted, factory bore sighted, and zeroed. No gross sighting procedures will be required. After assembly several small, one time, adjustments may be necessary.

EYE RELIEF

Shoulder your crossbow naturally with both eyes closed. Open your eyes and determine if a “full field” of view is achieved in the scope. If not, the scope will need to be moved closer or farther from your dominant eye.

This can be achieved by shortening or lengthening the stock by use of the Comfortek™ spacer system or by changing the scope ring location on the Monobloc™ scope dovetail.

If necessary, you can also move the scope forward or backward within the rings by simply loosening the two Torx® screws located in the top of the each of the scope ring caps. Once the scope has been moved, evenly retighten all Torx® cap screws.

DO NOT OVER TIGHTEN; over tightening may cause marring or damage to the scope tube.

NOTE: Recommended screw torque – Scope Ring Cap screws – 20 inch lbs. Clamp screw – 30 inch lbs.

EYE PIECE FOCUS

Once proper eye relief is achieved, proceed to the target range and bench rest. Aim at a target at 20 yards distance. Loosen the front locking ring on the rear eye piece. Next, adjust the eye piece in or out until the crosshairs and target are clearly in focus. Lock the ring firmly to the eye piece to secure it.

SIGHTING IN

Because your crossbow has been pre-sighted at the factory, you may now begin shooting to verify impact. Begin at a range of 20 yards using the top crosshair. Use sand bags or shooting rest to eliminate human error and rest the crossbow on the cocking stirrup to eliminate unwanted contact of limbs, cables and string with the rest.

Shoot three arrows at multiple aiming points to eliminate arrow to arrow contact. Measure the distance from center impact and adjust accordingly.

Your ARC crossbow scope features 1.25 Minute of Angle [MOA] turret adjustments. Accordingly, 1 click of adjustment equates to approximately 1/4" point of impact change at 20 yards range. For reference, your arrow shaft is a little less than 3/8" wide.

Remember the point of impact change will be greater per click beyond 20 yards and less per click than 20 yards. At 40 yards, one click will be less than approximately a 1/2" point of impact change and at 10 yards 1/8".

To make adjustments, first remove the turret cap then turn the adjustment knob as noted on the top of the knob. The adjustment knobs are knurled and can easily be adjusted by hand without the use of a tool.

The top turret controls elevation while the side turret controls windage. Turn the turret in the direction you want the arrow to go, i.e., if arrow impacts left, turn the windage turret right. If arrow impacts low, turn elevation turret up. **[See Figure 34]**



Figure 34

When sighting adjustment is complete at 20 yards, you may proceed to longer range targets to determine the impact distance of the lower four crosshairs. The ARC reticle will approximately deliver point of impact of 30, 40, 50, 60 and 70 yards respectively. The three dots that represent approximately 30, 40, and 50 yards cover about 1 1/4" at each distance. The point of intersection between the tip of the vertical duplex and fine crosshair is approximately 70 yards [called the tip of the chevron].

The top of the very small portion of vertical crosshair that extends above the main horizontal crosshair for a 10 yard reference. **[See Figure 35]**

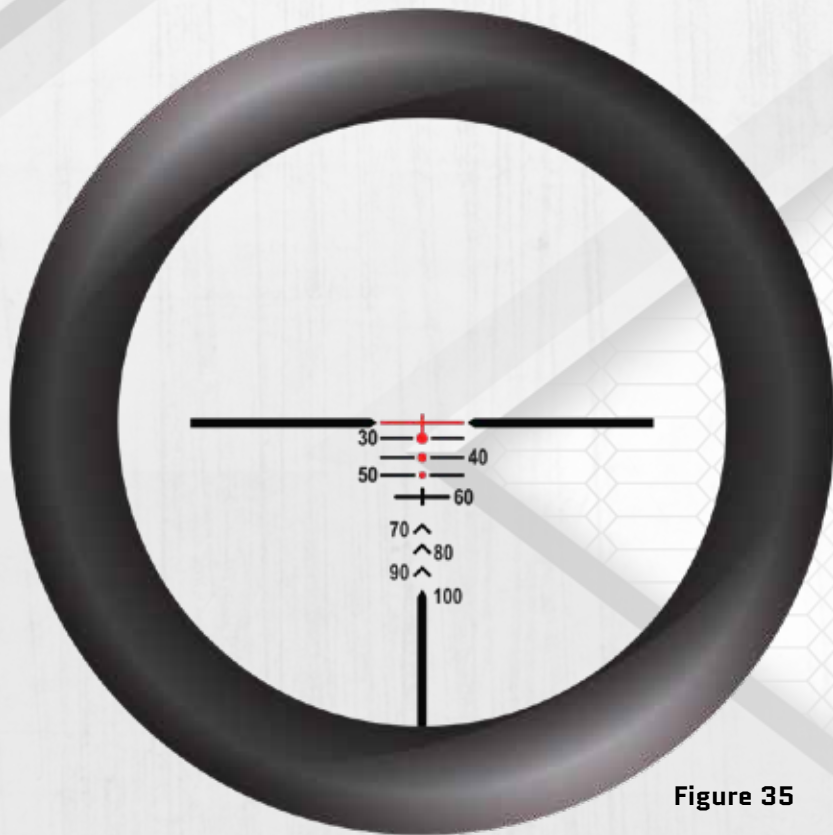

Figure 35



WARNING

Never mount or use the ARC 4 x 32 Crossbow Scope on rifles! The short eye relief of the crossbow scope will place the shooter's eye too close to the scope to allow for the recoil of a rifle. Personal injury to your eye or head is likely if this important warning is ignored!

HINT: For ultimate accuracy at all ranges, ensure that the vertical crosshair is perpendicular to the bow string and that the horizontal crosshairs are parallel with the bow string. [See Figure 36]



Figure 36

CHOOSING THE RIGHT ARROW

We spent hundreds of hours in the field and on the range to develop and supply the most consistent and accurate crossbow arrows for your CAMX Crossbow. Your new A4 has been supplied with CAMX Accuspine™ arrows to meet the challenge.

These wrapped carbon arrows have been engineered to provide optimum balance of speed, accuracy, durability, penetration, ballistic coefficient, and continued crossbow life. This arrow will serve the hunter well in harvesting all but the largest game on the earth.



For your safety and the safe operation of your crossbow, never shoot arrows that do not meet the following specifications:

18" minimum length
390 grains minimum, [total arrow weight]
11/32" or 0.346" diameter
Aluminum flat back nocks

It is crucial that you always select the proper arrow for your crossbow. Your crossbow stores tremendous energy and that energy is released through the arrow when fired.

ACCUSPINE ARROWS LOCK-N-LOAD INSERTS

All CAMX ACCUSPINE™ crossbow arrows include the Spot-On Lock-n-Load® precision glueless insert from Clean-Shot Archery, Inc. Not only are Lock-n-Load inserts glueless, they are also indexable and self-centering! Weighing 92 grains, this brass insert is made to Archery Manufacturers Association [AMO] industry standards and will work with any broadhead, fixed blades or mechanicals. The Lock-n-Load® insert has been extensively tested with field points and broadheads by CAMX in both bag and foam block targets.

Your Lock-n-Load® inserts can easily be indexed or rotated to align your vanes to the blades or any desired position for arrow to arrow consistency.

Insert removal and or rotation is accomplished by inserting a 5/64" hex key down into the insert and loosening the set screw at the bottom.

Once loose, the insert can be removed or rotated to the desired position and locked back into place by tightening the set screw with a 5/64" hex key.

NOTE: The Lock-n-Load® insert has been properly installed at the factory to a torque setting of 92 inch-ounces or 0.48 foot-pounds. When making adjustments, it is your responsibility to ensure you have the insert properly installed and tightened.

Over tightening can result in splitting the arrow shaft. When properly installed a small bulge in the arrow shaft should be apparent both visually and by feel at the base of the insert.

CAMX ALUMINUM FLAT NOCKS

The CAMX Flat Nock is press fitted, and can be easily removed should you chose to use a lighted nock. Simply unscrew your field point, and screw it into the back of the flat nock. With the aid of a vise or a pair of pliers pull the flat nock from the arrow shaft. Be careful not to damage the arrow shaft when removing the nock, or when installing aftermarket lighted nocks.

Before shooting, make a visual inspection of each arrow for damage. Flex the arrow slightly to reveal cracks, splinters, delamination or impact crush marks. Discard any arrow showing these signs. Inspect for loose fletchings and damaged flat backed nocks. Do not shoot these arrows until repaired.



Shooting a damaged arrow or shooting arrows that do not meet the manufacturer's recommendations is a dangerous practice that could result in injury or death to the shooter or others and will void CAMX warranty.

CROSSBOW TARGETS

To get full enjoyment from your newly purchased CAMX Crossbow, a properly designed target will be necessary for practice with both field points and broadheads. We believe that it is necessary to purchase two targets for best results: One suited for use with field or practice style points and another for use with broadheads or hunting tips.

We highly recommend a “bag” style target when shooting field points. Bag targets last a long time and are great for easy arrow removal when shot only with field points. Most bag targets also feature multiple aiming spots or targets allowing you to fully enjoy the accuracy of your new CAMX Crossbow without damaging arrows.

While we all like to shoot groups, remember that shooting groups with your CAMX crossbow will more than likely result in arrow damage as your crossbow is capable of shooting same hole groups.

When sighting in for hunting and shooting broadheads it will be necessary to use a foam or broadhead style target. There are many types and designs of broadhead targets available.

Many make claim that you can also use them with field points, however we do not recommend shooting field points into foam style block or layered broadhead targets. Arrow removal can be extremely difficult without a broadhead. It is possible to have the arrow components like the insert and point get lost in the target during arrow removal as the forces required to pull the arrow from the foam target are greater than the forces required to pull out the arrow components.

Remember, the job of the arrow and broadhead is to go through things. Today's foam broadhead targets are extremely dense so they can quickly stop arrows.

When shot with just field points, the point and arrow shaft will actually weld themselves to the foam from the friction used to stop the arrow. When used with a broadhead, the blades actually cut the foam and allow for expansion of the foam making broadhead arrow removal more manageable.

Remember that shooting broadheads into to a target is destructive from the very first shot and as time goes on it will be necessary to replace your broadhead target to ensure proper stopping of the arrow.

We also recommend the use of an arrow shaft lubricant when shooting into foam broadhead or 3D animal targets. A little will go a long way and make arrow removal much easier and enjoyable.

CARE, MAINTENANCE, STORAGE AND SERVICE

Your new CAMX crossbow is a high quality, precision hunting weapon. Occasionally, minimal maintenance is required to ensure your continued successes and the crossbow's performance. Prior to every outing, make a habit of conducting a quick inspection of strings, cables, cams, swingarms, arrows, and all fasteners. It's crucial that your crossbow is in safe working order prior to heading afield.

GENERAL CARE



NOTICE

Keep your crossbow clean and dry. Lightly lubricate trigger components, axles and steel components with a high quality gun oil to ensure performance and reduce rust and oxidation.

Store your crossbow in a cool dry place when not in use.

Never leave your crossbow exposed to extreme heat source such as a furnace vent or enclosed automobile trunk on a hot day. High heat is the enemy of crossbow limbs and synthetic strings and cables.

A padded crossbow case works well for long term storage and will keep your crossbow free of dust and debris.

When storing for long periods it is not necessary to relax or unstring the crossbow.

Proper maintenance will greatly extend the life of your Winner's Choice strings and cables. Your crossbow string and cables should be replaced prior to each season or as needed. Crossbow strings and cables are constructed of multiple fibers and as such require frequent lubrication to prevent fraying and dry rot.

A quality string/rail lubricant should be applied to exposed fibers. Extra lubricant should be applied to areas where the cables cross. Reapply as needed, especially after hunting in the rain.

Applying CAMX Barrel lubricant to the top surface of the barrel will promote a longer string life.

When applying a rail lubricant to the top surface of the barrel, be careful not to over lubricate or wax the center section of the string. Over lubrication may cause a build-up of lubricant in the trigger assembly adversely affecting its proper function and safety.





WARNING

IF YOUR STRING OR CABLES ARE FRAYED, SHOW SIGNS OF EXCESSIVE WEAR OR HAVE BROKEN STRANDS, REPLACE THE STRING OR CABLES IMMEDIATELY PRIOR TO SHOOTING.

NEVER SHOOT YOUR CROSSBOW IF THE CENTER SERVED PORTION OF THE STRING IS FRAYED, BROKEN OR MISSING.

USE ONLY GENUINE CAMX REPLACEMENT STRINGS, CABLES [BY WINNERS CHOICE] AND COMPONENTS. USE OF COMPONENTS OTHER THAN THOSE SUPPLIED, APPROVED AND/OR MANUFACTURED BY CAMX OUTDOORS INC. MAY NOT ONLY VOID YOUR WARRANTY BUT COULD RESULT IN BODILY INJURY.

FACTORY SERVICE



NOTICE

Although a local archery pro shop may be capable of routine string and cable changes, we highly recommend taking advantage of the CAMX factory service department when possible, for all your service needs. Our team of trained technicians are familiar with all aspects of your crossbow and will perform any service operation professionally and promptly.

LIMITED LIFETIME WARRANTY:

CAMX stands behind the workmanship and overall quality of its products through a Limited Lifetime Warranty to the **ORIGINAL OWNER** for its useful life [not to exceed ten years], with a valid sales receipt. This Limited Lifetime Warranty is non-transferable and is on valid only on the purchase of a new product from an authorized retailer or distributor.

CAMX crossbows must be registered online within 30 days of purchase to activate the warranty at **Camxcrossbows.com/warranty**

THIS WARRANTY COVERS AGAINST DEFECTS IN MATERIAL AND WORKMANSHIP FOR THE LIFETIME OF THE BOW WITH THE FOLLOWING EXCEPTIONS:

COVERED FOR 5 YEARS FROM DATE OF PURCHASE

- Limbs
- Optics
- Cocking Devices

NOT COVERED UNDER WARRANTY

Any Normal Wear items [examples below]:

- Strings and Cables
- Cable Slide
- Dampeners
- Bearings

CAMX reserves the right to deny warranty coverage in the event, that misuse is observed. Examples of misuse include but are not limited to:

- 1.The instructions in the owner's manual are not followed;
- 2.The crossbow or any of its parts are altered from their original state;
- 3.The PAR™ System, Thumbsaver™, or ThumbSaver II™ systems are disabled, altered, or removed;
- 4.Damage is caused by abuse or neglect;
- 5.Damage is caused by dry-firing or by using underweight arrows (lighter than recommended in the owner's manual); or
- 6.The crossbow is rented or loaned for use by others by a retailer, wholesaler, or shooting range operator, or other commercial business organization, whether or not a fee is charged for its use.

CAMX retains the right to replace components with equivalent components that may be of different design or decoration. CAMX may also request to visually inspect failed components prior to issuing parts and/or service.

PRODUCT RETURN POLICY:

In the event an item requires warranty service, please contact The CAMX warranty department at **877-503-5483** for a Return Merchandise Authorization [RMA] number. Returns received without authorization will not be processed for repair, refund, or exchange.

1. All repairs, replacements, and refunds will be determined by CAMX. All requests are subject to approval by CAMX.
2. Any product[s] returned without RMA number will not be accepted. Do not send your product[s] until you received an RMA number.
3. All RMA requests must include a photo of the product[s].
4. Shipping expenses will be incurred by the customer. The Outdoor Group will cover the return shipping cost of the product[s] being returned to you.

5. An RMA approval does not guarantee that the product is covered by warranty. All returns are subject to inspection upon arrival.

6. If the item is under warranty and a repair is not possible, a replacement product will be sent. The original product will NOT be returned.

7. A copy of the original receipt is required for all RMA requests.

In the event we find that the item is not covered under warranty. We will contact you with a quoted repair cost. If you don't want to pay for the repairs, it is your responsibility to pay for shipping back to you. Returned product not paid for within 90 days will be discarded.

There are no warranties which extend beyond the description on the face hereof.

The sole and exclusive remedy pursuant to this warranty is the repair or replacement of the defective part[s] at the sole discretion of CAMX Crossbows. Parts determined to be unsafe will not be returned with the repaired crossbow. Repair or replacement part colors and/or patterns may not match original part[s].

The implied warranties of merchantability and fitness for a particular purpose are expressly disclaimed.

All disclaimers and limitations of liability shall still apply even if the limited remedy and replacement fails in its essential purpose.

In states where permitted, we assume no liability for incidental or consequential damage or for incidental expenses.

Any action against CAMX Crossbows based on an alleged breach of this warranty must be brought within one (1) year of the claimed breach.

CAMX Crossbows liability for any breach of warranty shall be limited to repair or replacement of the product at the option of CAMX Crossbows.

AMERICAN MADE

Our vision is to build products and do business the American way. **Build them right. Build them better. Build them to last. Build them here.** Sell them for a fair price and stand behind the work. We want customers who appreciate value, not only in the price paid, but in reliability, performance, safety and enjoyment over the years.

GUARANTEE

ACCURACY – Your new CAMX crossbow is guaranteed to group 1" or less at 20 yards with the arrows provided in the CAMX "Peak Performance" system. All crossbows will be assembled and test shot for guaranteed accuracy before shipping to you.

PERFORMANCE – Your new CAMX crossbow will shoot the advertised speed. All crossbows will be chronograph verified to meet or exceed published speed ratings with supplied ACCUSPINE™ arrows before shipping to you.

CAMX PERFORMANCE ACCESSORIES

ACCUSPINE™ ARROWS

85000058
18" [4Pack]



LOW READY SLING™ (Patented)

85000017 Realtree™ XTRA
85000045 Black



XBOW BROADHEADS (Patented)

15ST100X 100 GR 4 PACK
15ST125X 125 GR 4 PACK
15ST150X 150 GR 4 PACK

WAX & BARREL LUBE KIT

85000003 Kit
85000004 String Wax
85000005 Barrel Lube



SLIDER ROPE COCKER 85000002



WISHBONE™ SIDEMOUNT QUIVER (Patented)

85000012 Realtree™ XTRA
85000016 Black





THE OUTDOOR GROUPTM LLC

LIABILITY DISCLAIMER

The Outdoor Group, LLC is not liable for any personal injury, death, or property damage that may result from your use of this product. The user of this product assumes all risks of property damage or injury to yourself and others that may arise from its use. Use of this product binds the user to this agreement.

CAMX Crossbows Customer Service | (877) 503-5483 | 1325 John St. Rochester, NY 14586 | www.camxcrossbows.com

Copyright 2018

For additional patent information, please visit:
<https://camxcrossbows.com/pages/patents>