



Congratulations on your Guide Gear® purchase.

Enjoy your new Guide Gear® item with confidence, knowing it has been designed and built to deliver dependable quality and performance at an exceptional value.

**Item #712140 Guide Gear® Folding Aluminum Cargo Carrier with 3-Position Ramp**



For assistance with your product, please contact Sportsman's Guide customer service at 1-800-888-3006 Mon.-Fri. 7:00am to 9:00pm, Sat.-Sun. 8:00am to 8:00pm CST or go to [sportsmansguide.com/customerservice/contactus](http://sportsmansguide.com/customerservice/contactus)



## WARNINGS AND CAUTIONS

- Read and understand all warnings, cautions, assembly, installation and use instructions prior to assembling, installing or using this product. Failure to follow all warnings, cautions and instructions may result in serious injury or damage to personal property. Retain this manual for future reference.
- Confirm all parts are present before assembly. If any part is missing, cracked or damaged, please contact Sportsman's Guide customer service before assembly.
- **NEVER** exceed maximum tongue weight recommended by the manufacturer of the vehicle the cargo carrier is to be installed on (total weight of the carrier plus cargo). For many vehicles this will be lower than the maximum weight capacity of the cargo carrier.
- **NEVER** exceed the maximum weight of 500 pounds (227 kgs) on this cargo carrier.

 **WARNING:** This package contains small parts and is a choking hazard, keep away from children and pets.

- **NEVER** allow other persons to assemble, install or use this product until they have read this manual and have developed a thorough understanding of how the product works.
- **NEVER** attempt to modify this product or subject it to an installation or use for which it was not designed. Doing so may result in damage and/or serious injury.
- **NEVER** use the carrier for a purpose for which it was not intended.
- **NEVER** carry loads wider or deeper than the carrier.
- **NEVER** carry flammable items on the carrier.

 **WARNING:** **NEVER** allow exhaust fumes to blow directly on cargo or straps secured to the carrier. This is fire hazard and could also lead to cargo coming loose.

- **ALWAYS** use the carrier on a flat, level surface capable of supporting the aluminum cargo carrier and its maximum load. Pulling or pushing a load on a slanted or uneven surface can result in loss of control.
- **NEVER** use the carrier to transport people, animals or flammable liquids or gases.
- **ALWAYS** follow all federal, state and local department of transportation regulations governing installation and use.
- **ALWAYS** keep children and bystanders away from the work area while assembling, installing, loading/unloading the carrier.
- **ALWAYS** reduce your speed as your vehicle will handle differently when the carrier is in use.
- **FREQUENTLY** check your cargo to make sure it is secure. Cargo can shift or the carrier may loosen during travel. Readjust as necessary and if it persists, stop use.
- **ALWAYS** remove all cargo before removing carrier from the vehicle.
- **NEVER** obscure vehicle taillights with cargo on the carrier.
- **ALWAYS** thoroughly inspect your product for loose parts and/or signs of damage prior to each use, installation or removal. **NEVER** use until any loose parts have been properly secured or damaged parts have been properly replaced.
- **ALWAYS** distribute the load evenly. Uneven loads may cause the aluminum cargo carrier to tip, resulting in personal injury to the operator or others. To minimize the effects of dynamic loading, make sure the load is centered on the carrier.
- **ALWAYS** insure weight is evenly distributed and cargo is completely secured to the carrier and will not shift during transport. Bungee cords or other elastic cords are NOT recommended for securing loads because they stretch and/or snap allowing loads to come loose.
- Be aware of dynamic loading! Sudden load movement may briefly create excess load causing product failure.
- **ALWAYS** insure the carrier ramp is folded and secured before transit.
- **NEVER** attempt to assemble, install, load or unload the carrier while you are tired or under the influence of drugs or alcohol.
- **ALWAYS** wear appropriate safety gear such as ANSI-approved safety goggles and heavy-duty work gloves when assembling, installing, loading, unloading or removing/storing the carrier.
- The warnings, cautions, and instructions in this manual cannot cover all possible conditions or situations that could occur. Exercise common sense and caution when using this product. Always be aware of the environment and ensure that the product is used in a safe and responsible manner.

# Parts List & Diagram

ITEM #	Qty	Description
1	1	the bottom bracket
2	4	U clamp
3	9	M10 lock nut
4	4	M10×45mm ring screw
5	1	Carrier frame
6	1	The spoon shaped fixed plate
7	1	M10×25mm button socket cap screw
8	2	M10×20mm ring screw
9	1	10 flat washer
10	1	Z type rotating mechanism
11	1	M16×85mm hexagon bolt

ITEM #	Qty	Description
12	1	M16 lock nut
13	1	Pin
14	2	3.8 split pin
15	1	M16 shockproof bolt
16	1	16 spring washer
17	2	16 flat washer
18	2	M10x20mm button socket cap screw
19	1	Upper ramp
20	1	Lower ramp

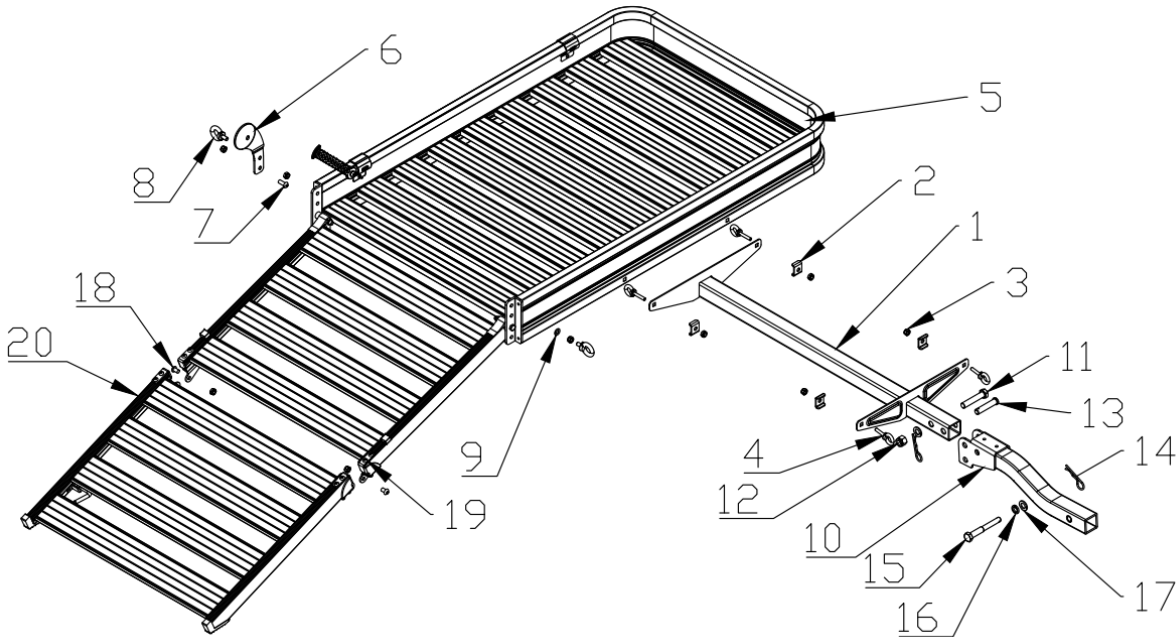

## Tools Required



Open Wrench (1 pc.)  
Size=17mm



Open Wrench  
Size=24mm



Adjustable wrench  
Size=0-30mm



Hex Key  
Size=6mm

## ASSEMBLY INSTRUCTIONS

### STEP 1

1. Pass the M10x20 Hexagon Flat Head Screw (18#) through the lower ramp (20#), and then through the upper ramp (19#). Use the M10 lock nut (3#) to tighten to 80% tightness, so that the two ramps can rotate smoothly. See FIG 1

FIG. 1

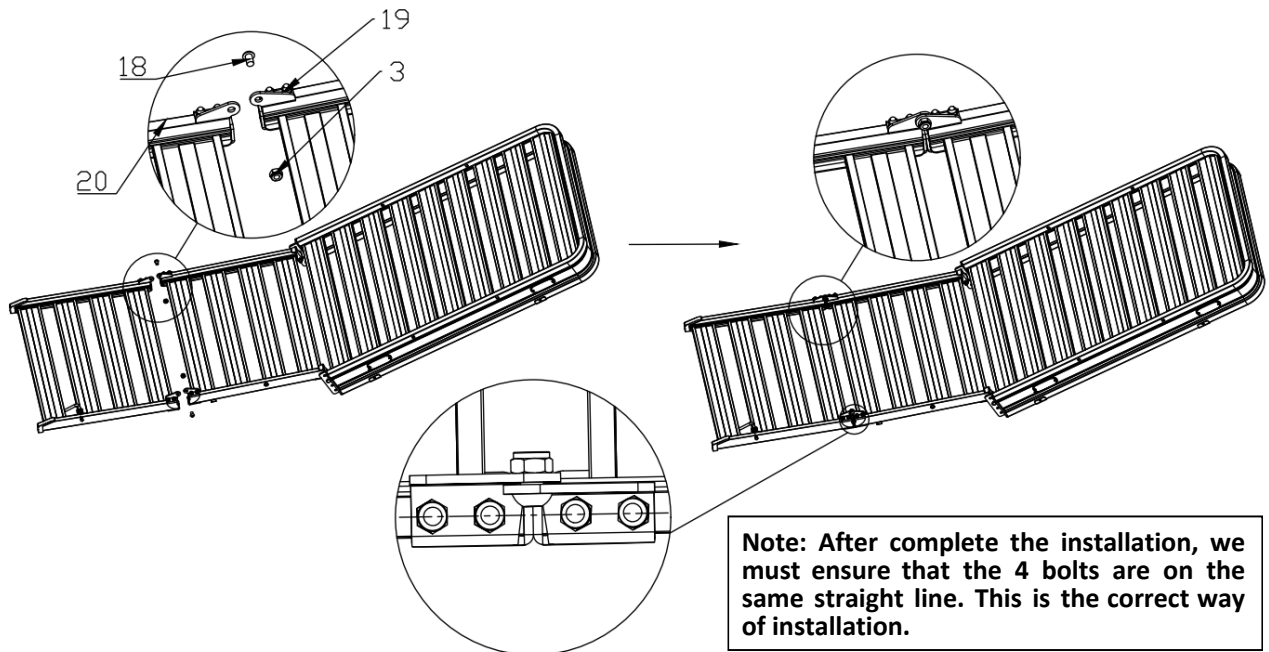

### STEP 2

2. Place the bottom bracket (1#) on the bottom of the carrier frame (5#) and position the square hole. The M10\*45mm ring screw (4#) is then passed through the bottom bracket (1#) and the carrier frame (5#) and the U clamp (2#). The M10 lock nut (3#) is finally tightened. See FIG 2.

FIG 2

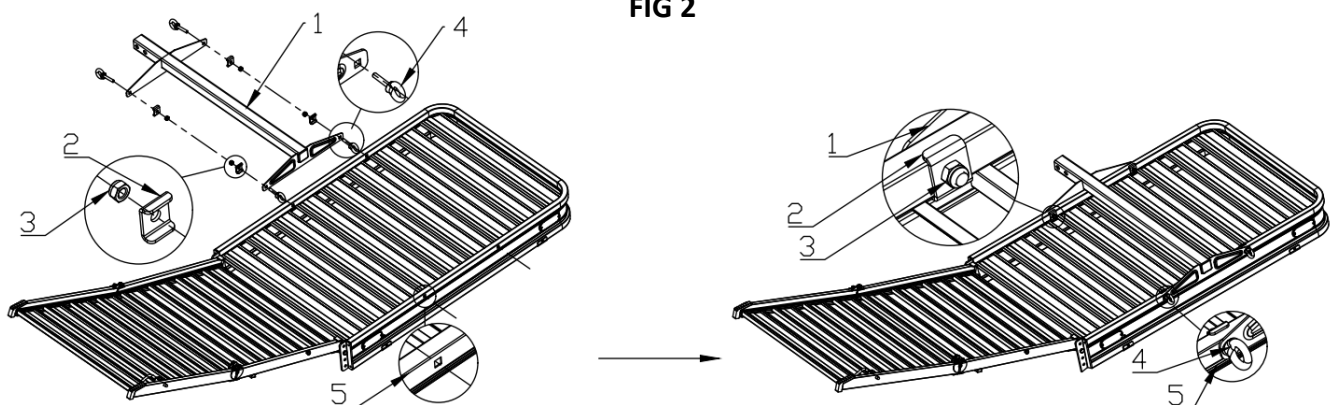

The head of the ring screw (4#) goes towards the outer side of the carrier frame (5#).

### STEP 3

3. The spoon shaped fixed plate (6#) protrusion side is faced to the inside of the carrier frame (5#) and is mounted on the left of the carrier frame (5#), aligns two round holes, so that the M10 x 20mm ring screw (8#) passes through the spoon shaped plate (6#) and the upper round hole of the carrier frame (5#) in turn, and then uses the M10 lock nut (3#) to tighten. The button socket cap screw M10 x 25mm (7#) from the inside of the carrier frame (5#) through the carrier frame (5#) and the spoon shaped fixed plate (6#) from the top of the second round holes, and then the M10 lock nut (3#) tightened. Finally, the M10 x 20mm ring screw (8#) is made from the right side of the 10 flat washer (9#) and the upper first round hole of the carrier frame (5#) from the right side of the carrier frame (5#), and the M10 lock nut (3#) is tightened. See FIG 3.

FIG 3

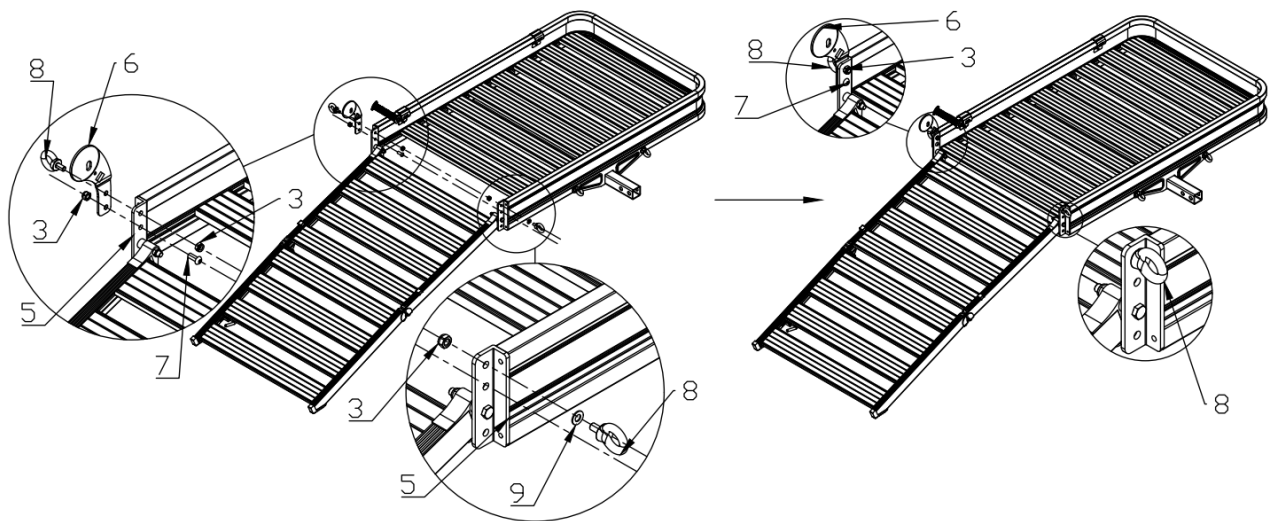

### STEP 4

4. The Z type rotating mechanism (10#) is set on the bottom bracket (1#) square tube, the position of the two circular holes is aligned, and then the M16 x 80mm hexagon bolt (11#) passes through the Z rotary mechanism (10#) and the bottom bracket (1#) near the carrier rack's round hole, and then uses the M16 lock nut (12#) to tighten. The pin (13#) is passed through the Z rotary mechanism (10#) and the bottom bracket (1#) another circular hole, and the 3.8 split pin (14#) is used to cross the hole limit on the pin (13#). Finally, the Z type rotating mechanism (10#) is inserted into the receiver of the rear of the car, and the thread holes of the Z type rotating mechanism (10#) are aligned with the circular hole of the receiver. After the M16 shock proof bolt (15#) passes through the 16 spring washer (16#) and the 16 flat washer (17#), the screw holes of the Z rotary mechanism (10#) are swirled from the receiver's circular hole. After tightening, the 3.8 split pin (14#) passes through the hole limit on the M16 shockproof bolt (15#). See FIG 4.

FIG. 4

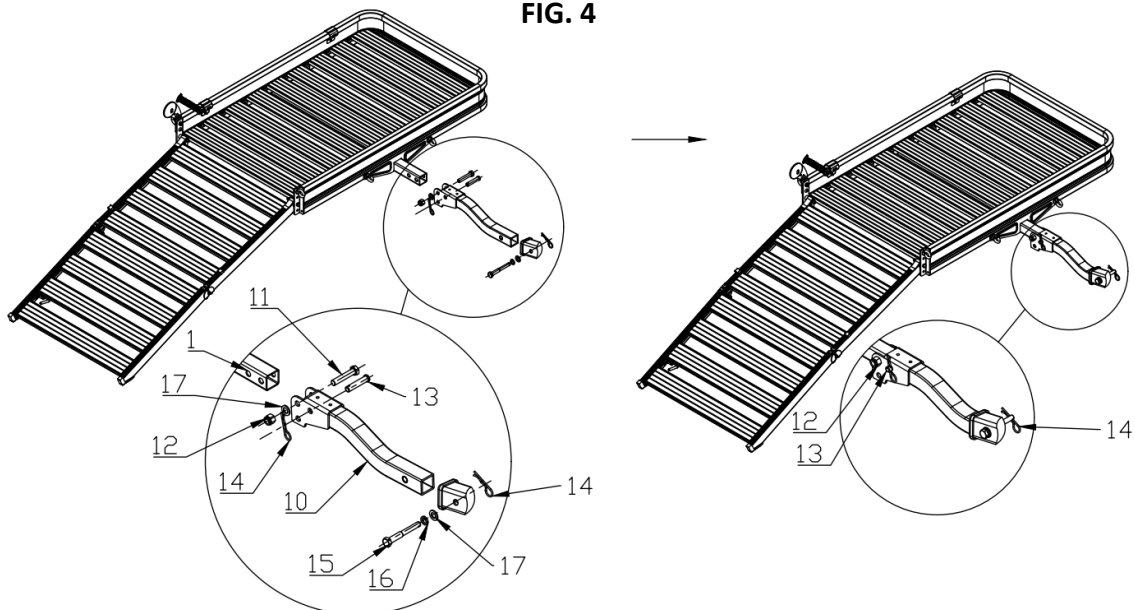

### STEP 5

5. When the ramp is in the upright state, fasten the rubber belt on the step bolt of the ramp to reduce the rattle. See FIG 5

FIG. 5

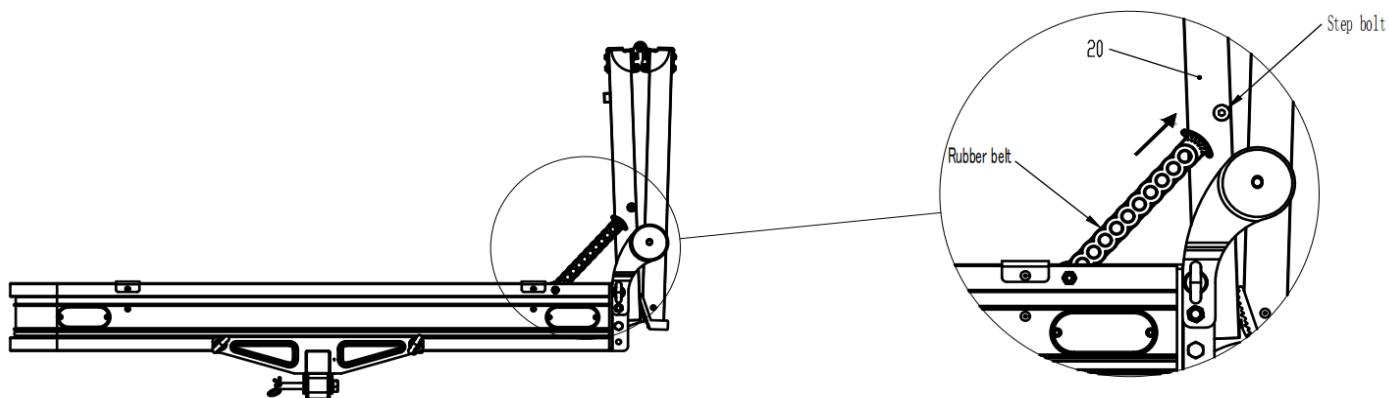

### STEP 6

Folding steps. See FIG 6.

FIG. 6

