

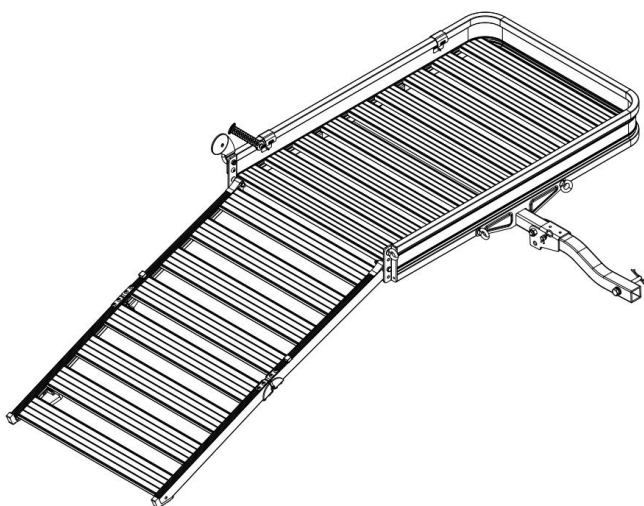

Congratulations on your **Guide Gear** purchase.  
Take your game to the next level with field-tested **Guide Gear** products for a confident, competitive edge that strikes the perfect balance between performance and value.

**INSTRUCTIONS FOR ASSEMBLY AND USE OF  
ITEM# 712142 - Guide Gear ALUMINUM CARRIER**



For assistance with your Guide Gear product, please contact the Sportsman's Guide customer service at 1-800-888-5222 7:30am – 6:00pm CST Mon-Fri or go to <http://www.sportsmansguide.com/customerservice/contactus>



**#ShareTheThrill**

[www.SportsmansGuide.com](http://www.SportsmansGuide.com)

---

## WARNING

Read carefully and understand all **ASSEMBLY AND OPERATION INSTRUCTIONS** before operating. Failure to follow the safety rules and other basic safety precautions may result in serious personal injury.

## INTENDED USE

This cargo carrier fits in a 2in. receiver and can carry up to a 500-lb. load. It is ideal for use as a mobility carrier, a transporter for lawn equipment or to provide additional cargo space.

## SAVE THESE INSTRUCTIONS

## WORK AREA

- Keep work area clean, free of clutter and well lit. Cluttered and dark work areas can cause accidents.
- Keep children and bystanders away while operating the aluminum cargo carrier. Distractions can cause you to lose control, so visitors should remain at a safe distance from the work area.
- Be aware of all power lines, electrical circuits, water pipes and other mechanical hazards in your work area, particularly those hazards below the work surface hidden from the operator's view that may be unintentionally contacted and may cause personal harm or property damage.
- Be alert of your surroundings. Using the aluminum cargo carrier in confined work areas may put you dangerously close to cutting tools and rotating parts.

## PERSONAL SAFETY

- Stay alert, watch what you are doing and use common sense when using the aluminum cargo carrier. Do not use the aluminum cargo carrier while you are tired or under the influence of drugs, alcohol or medication. A moment of inattention while operating an aluminum cargo carrier may result in serious personal injury.
- Dress properly. Do not wear loose clothing, dangling objects, or jewelry. Keep your hair, clothing and gloves away from moving parts. Loose clothes, jewelry or long hair can be caught in moving parts.
- Use safety apparel and equipment. Use safety goggles or safety glasses with side shields which comply with current national standards, or when needed, a face shield. Use as dust mask in dusty work conditions. This applies to all persons in the work area. Also use non-skid safety shoes, hardhat, gloves, dust collection systems, and hearing protection when appropriate.

## ALUMINUM CARGO CARRIER USE AND CARE

- Do not modify the aluminum cargo carrier in any way. Unauthorized modification may impair the function and/or safety and could affect the life of the equipment. There are specific applications for which the aluminum cargo carrier was designed.
- Always check of damaged or worn out parts before using the aluminum cargo carrier. Broken parts will affect the aluminum cargo carrier operation. Replace or repair damaged or worn parts immediately.
- Do not exceed the aluminum cargo carrier load capacity.
- Distribute the load evenly. Uneven loads may cause the aluminum cargo carrier to tip, resulting in personal injury to the operator or others. To minimize the effects of dynamic loading, make sure the load is centered on the carrier.
- Use the aluminum cargo carrier on flat and level surfaces capable of supporting the aluminum cargo carrier and its

maximum load. Pulling or pushing a load on a slanted or uneven surface can result in loss of control.

- Prior to transporting a load, make sure the Ramp of the carrier is folded and secured. The load itself must also be properly secured to the carrier.
- Store idle the aluminum cargo carrier. When the aluminum cargo carrier is not in use, store it in a secure place out of the reach of children. Inspect it for good working condition prior to storage and before re-use.



**WARNING: Flammable cargo can ignite from exposure to heat. Be aware of the possible fire risk and property damage resulting from the vehicle's exhaust system pointing at or running near the cargo in the carrier. Do not use if this condition exists.**

## Tools Needed



Open Wrench (1 pc.)  
Size=17mm



Open Wrench (1 pc.)  
Size=24mm



Adjustable wrench (1 pc.)  
Size=0-30mm



Hex Key (1 pc.)  
Size=6mm

## ASSEMBLY

### Carrier Assembly

#### STEP 1

1. Pass the M10x20 Hexagon Flat Head Screw (18#) through the lower ramp (20#), and then through the upper ramp (19#). Use the M10 lock nut (3#) to tighten to 80% tightness, so that the two ramps can rotate smoothly. See FIG 1

**FIG. 1**

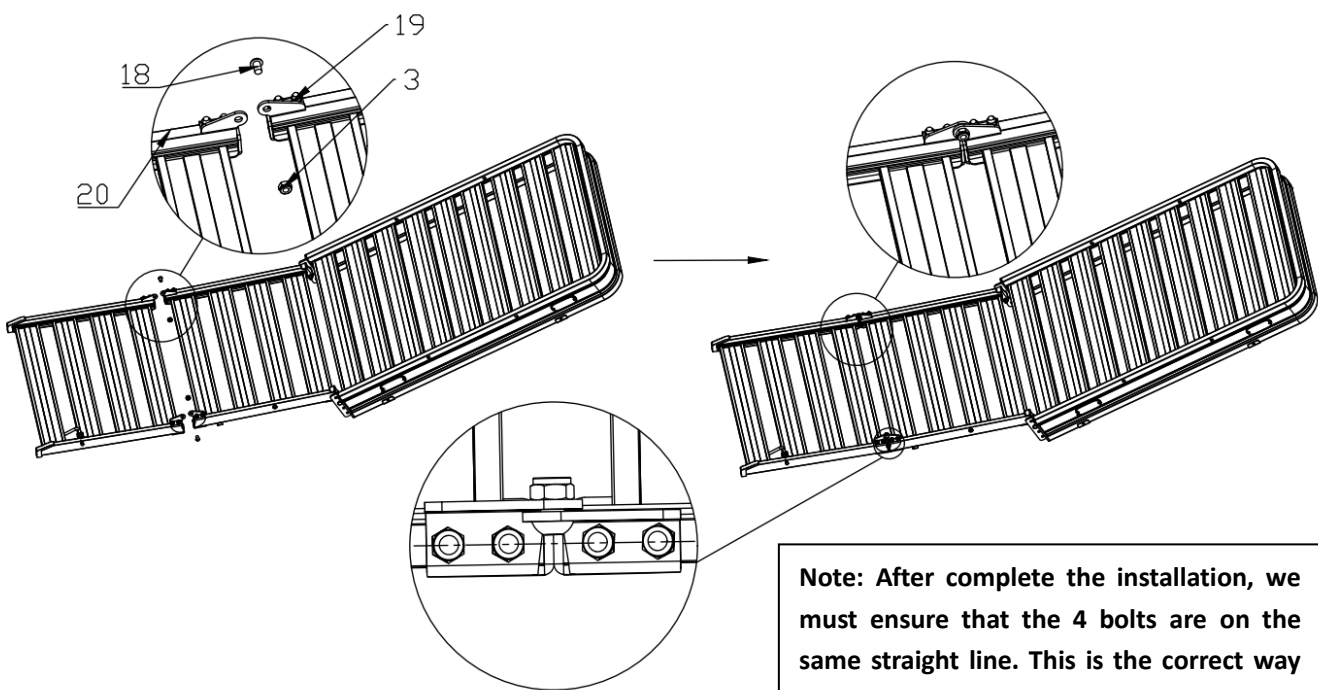

## STEP 2

2. Place the bottom bracket (1#) on the bottom of the carrier frame (5#) and position the square hole. The M10\*45mm ring screw (4#) is then passed through the bottom bracket (1#) and the carrier frame (5#) and the U clamp (2#). The M10 lock nut (3#) is finally tightened. See FIG 2.

FIG 2

The head of the ring screw (4#) goes towards the outer side of the carrier frame (5#).

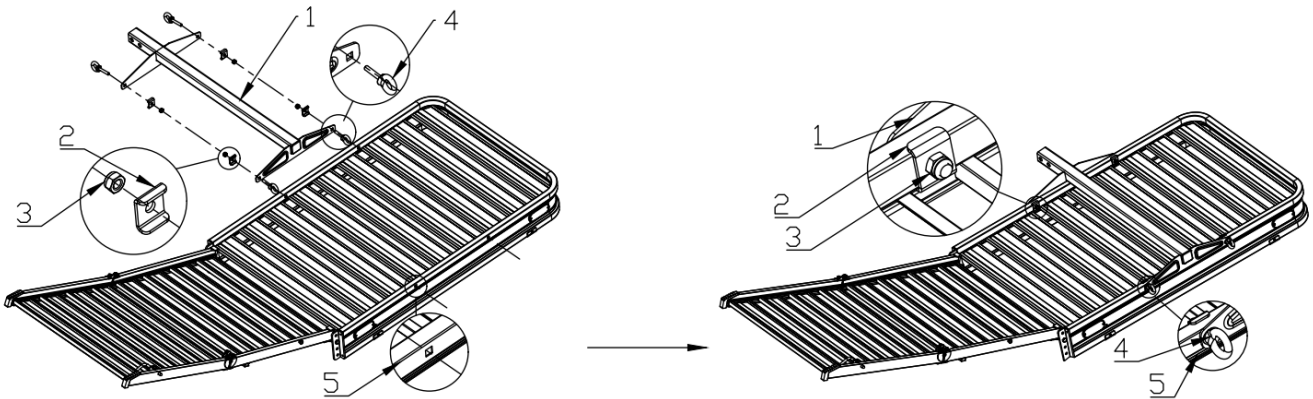

## STEP 3

3. The spoon shaped fixed plate (6#) protrusion side is faced to the inside of the carrier frame (5#) and is mounted on the left of the carrier frame (5#), aligns two round holes, so that the M10 x 20mm ring screw (8#) passes through the spoon shaped plate (6#) and the upper round hole of the carrier frame (5#) in turn, and then uses the M10 lock nut (3#) to tighten. The button socket cap screw M10 x 25mm (7#) from the inside of the carrier frame (5#) through the carrier frame (5#) and the spoon shaped fixed plate (6#) from the top of the second round holes, and then the M10 lock nut (3#) tightened. Finally, the M10 x 20mm ring screw (8#) is made from the right side of the 10 flat washer (9#) and the upper first round hole of the carrier frame (5#) from the right side of the carrier frame (5#), and the M10 lock nut (3#) is tightened. See FIG 3.

FIG 3

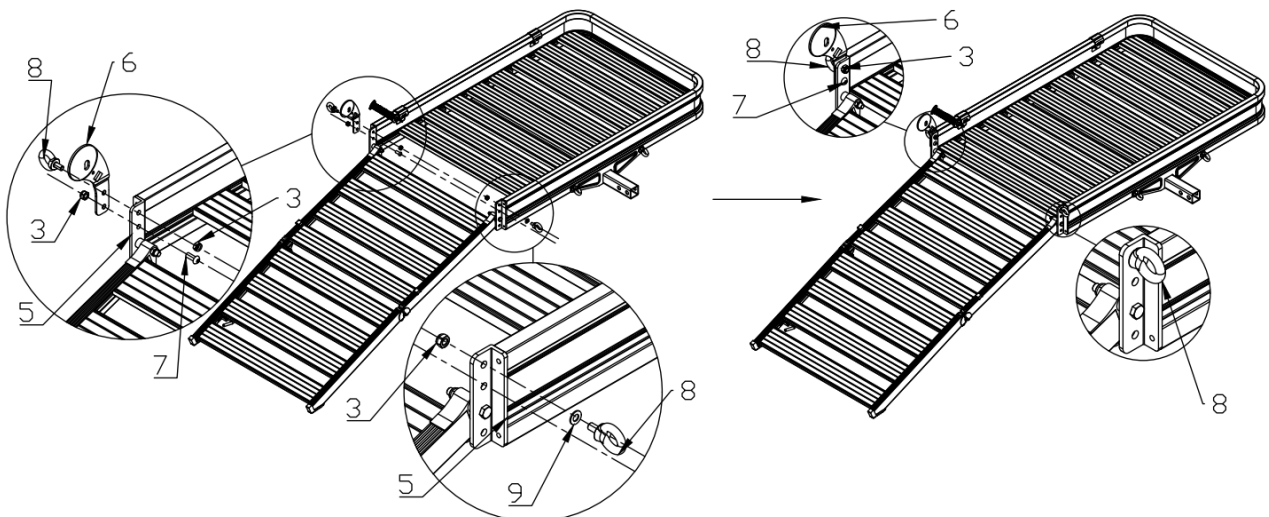

#### STEP 4

4. The Z type rotating mechanism (10#) is set on the bottom bracket (1#) square tube, the position of the two circular holes is aligned, and then the M16 x 80mm hexagon bolt (11#) passes through the Z rotary mechanism (10#) and the bottom bracket (1#) near the carrier rack's round hole, and then uses the M16 lock nut (12#) to tighten. The pin (13#) is passed through the Z rotary mechanism (10#) and the bottom bracket (1#) another circular hole, and the 3.8 split pin (14#) is used to cross the hole limit on the pin (13#). Finally, the Z type rotating mechanism (10#) is inserted into the receiver of the rear of the car, and the thread holes of the Z type rotating mechanism (10#) are aligned with the circular hole of the receiver. After the M16 shock proof bolt (15#) passes through the 16 spring washer (16#) and the 16 flat washer (17#), the screw holes of the Z rotary mechanism (10#) are swirled from the receiver's circular hole. After tightening, the 3.8 split pin (14#) passes through the hole limit on the M16 shockproof bolt (15#). See FIG 4.

FIG. 4

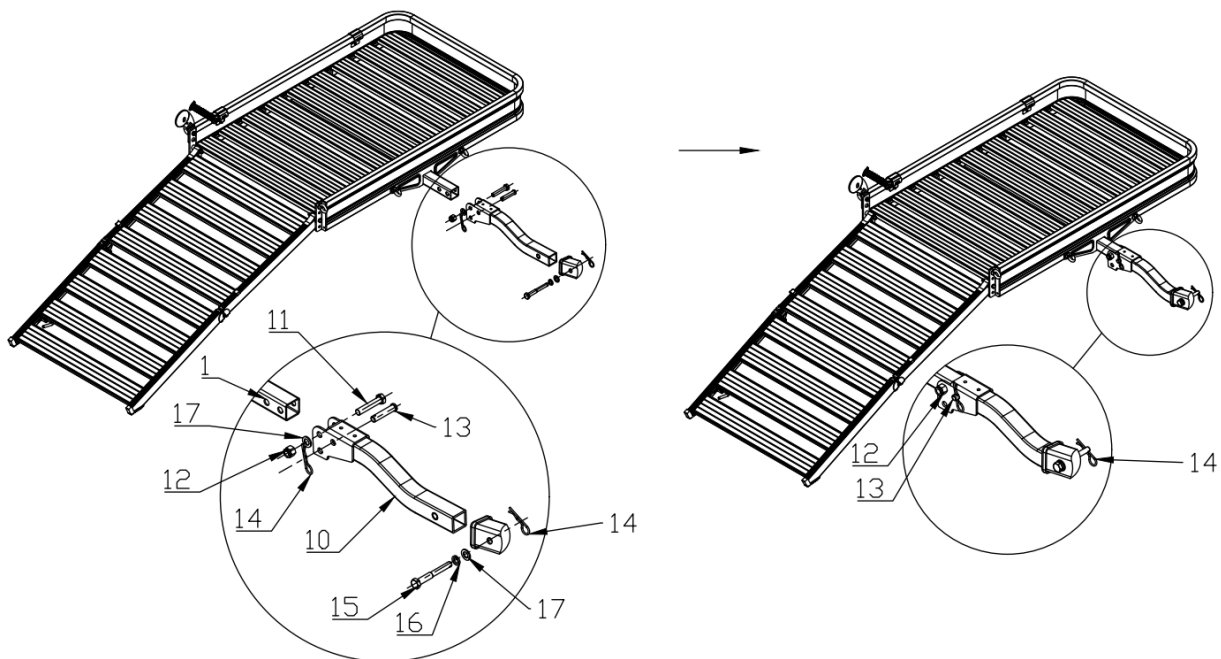

#### STEP 5

5. When the ramp is in the upright state, fasten the rubber belt on the step bolt of the ramp to reduce the rattle. See FIG 5

FIG. 5

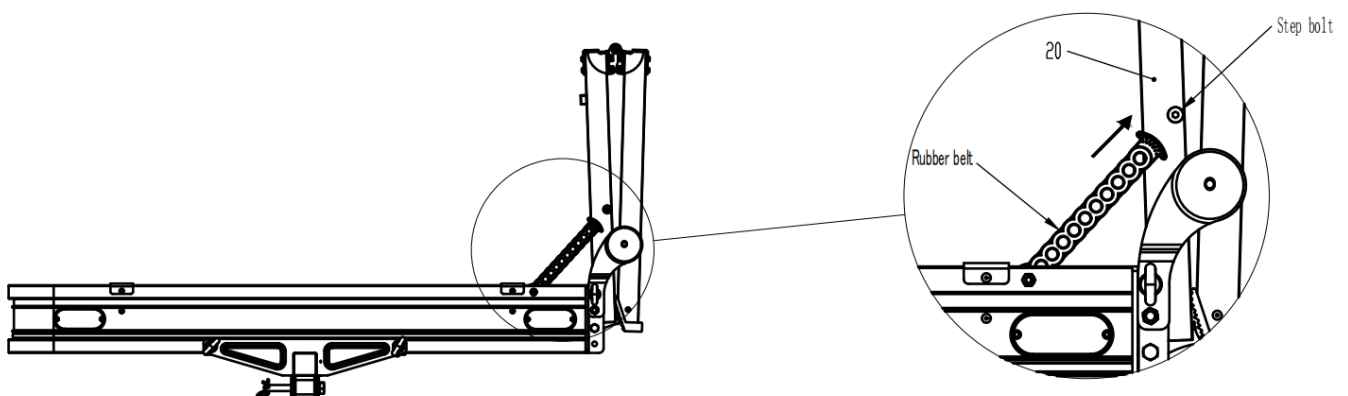

## STEP 6

Folding steps. See FIG 6.

FIG. 6

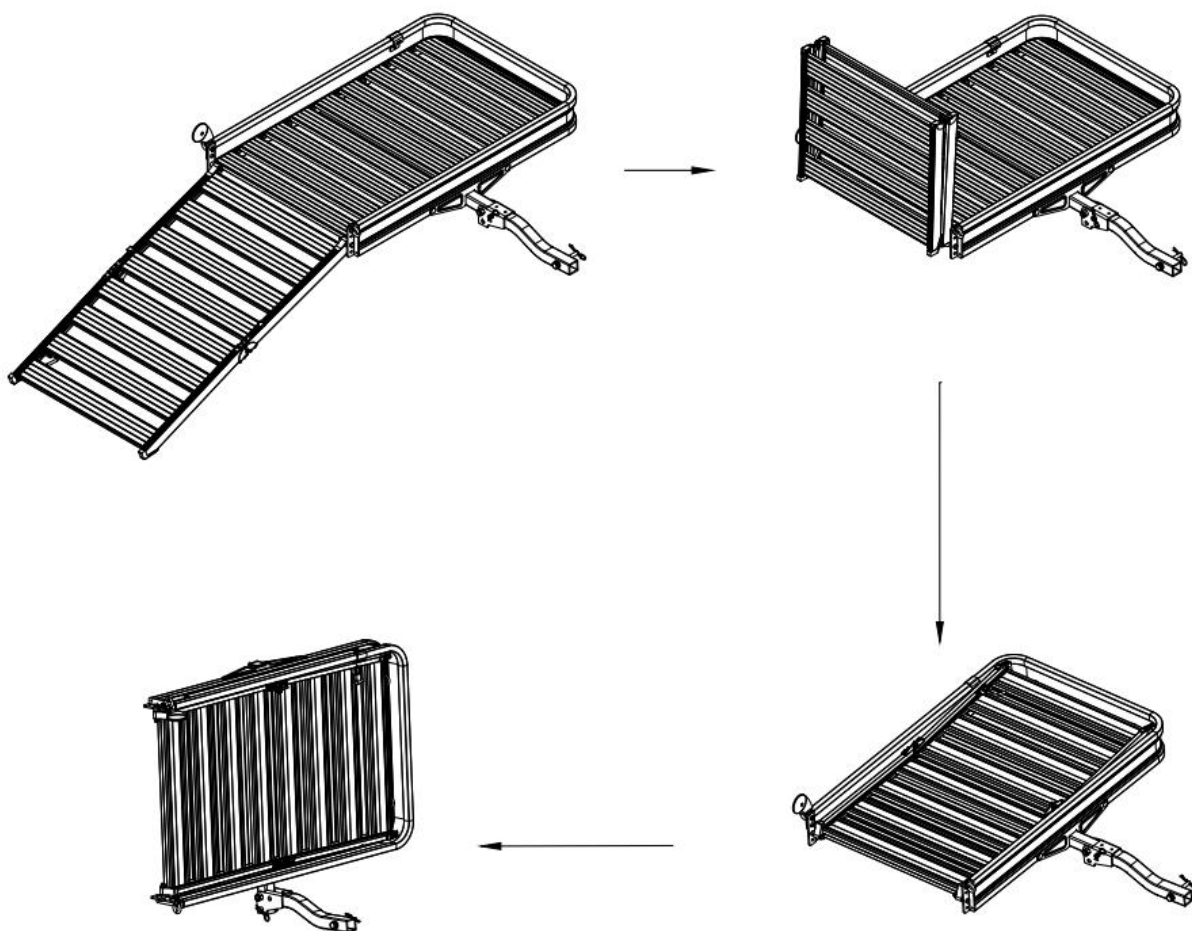

## Diagram & Parts List

ITEM #	Qty	Description
1	1	the bottom bracket
2	4	U clamp
3	9	M10 lock nut
4	4	M10×45mm ring screw
5	1	Carrier frame
6	1	The spoon shaped fixed plate
7	1	M10×25mm button socket cap screw
8	2	M10×20mm ring screw
9	1	10 flat washer
10	1	Z type rotating mechanism
11	1	M16×85mm hexagon bolt
12	1	M16 lock nut
13	1	Pin
14	2	3.8 split pin
15	1	M16 shockproof bolt
16	1	16 spring washer
17	2	16 flat washer
18	2	M10×20mm button socket cap screw
19	1	Upper ramp
20	1	Lower ramp

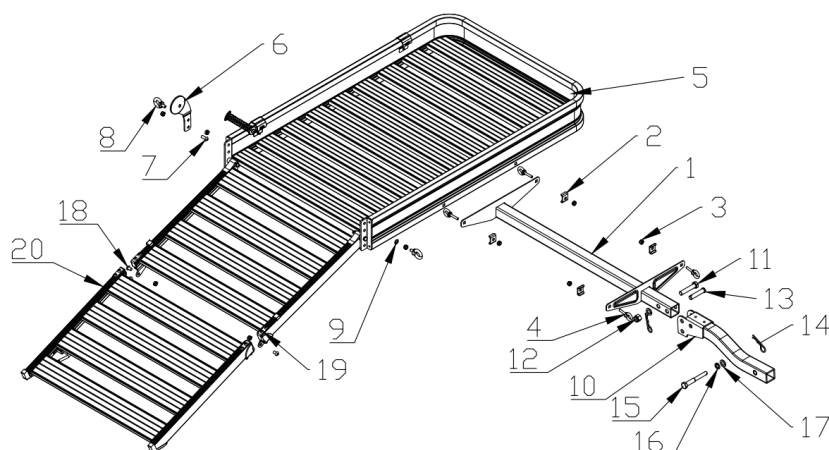

For replacement parts and technical questions, please call **1-800-222-5381**.

## WARRANTY

**One-year limited warranty**